

**Kossuth County, Iowa**  
Iowa North Zone (1401)  
Horiz. Datum: NAD83(1996)  
Vert. Datum: NAVD 1988  
US Survey Feet  
**2005**

Point Name: **505**

**Designation:** 2005-505 Kossuth Co GPS Control Point

Northing: **4010518.48sft** Easting: **4733819.25sft**

Orthometric Height: **1134.24sft** Ellipsoid Height: **1041.32sft** **Geoid03**

Latitude: **43°30'00.12210"N** Longitude: **94°12'22.83989"W**

Mapping Angle: **-0°28'43"** Combination Scale Factor: **1.000001320**

**Monument Type:** Berntsen Top Security Rod Monument with a 2-1/2" dia. domed survey cap and permanent magnet encased in a 6"dia. PVC pipe with a NGS style aluminum access cover.

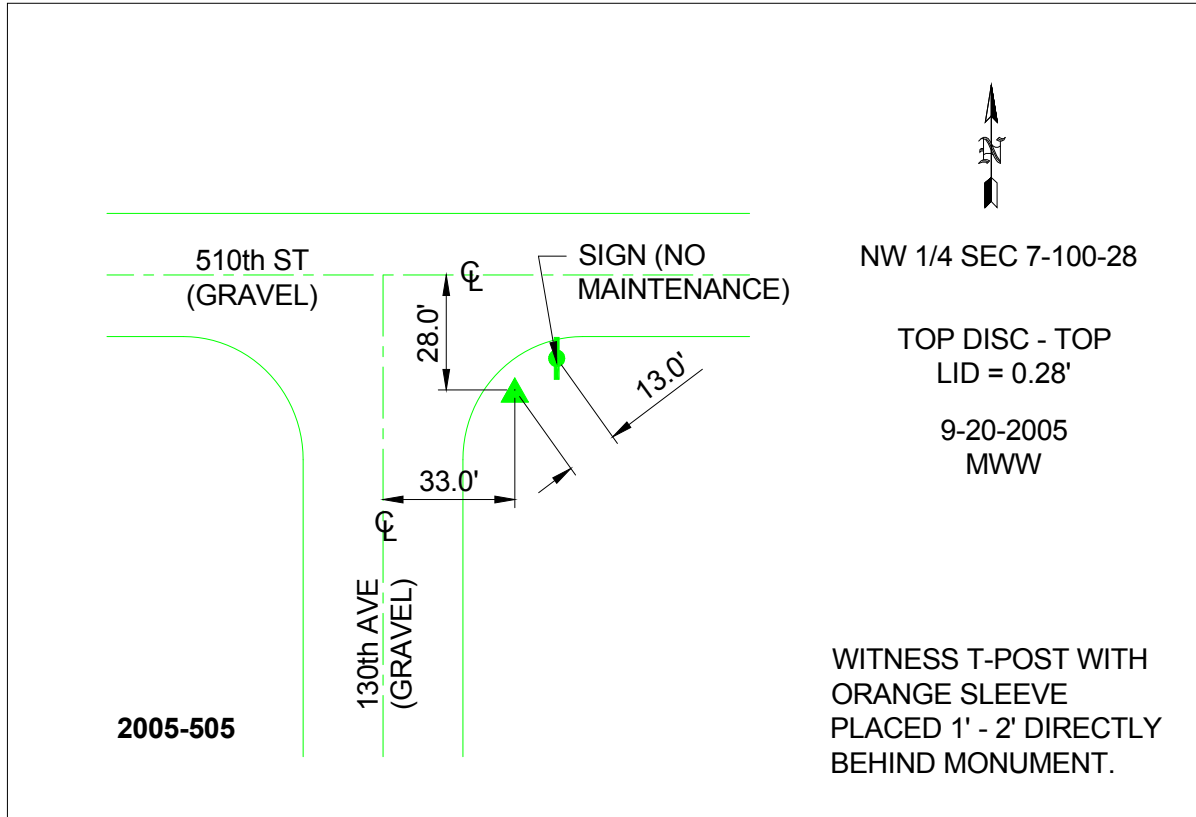

*This document was prepared by DCI and GBC for use by Kossuth County, Iowa.*