

**Kossuth County, Iowa**  
Iowa North Zone (1401)  
Horiz. Datum: NAD83(1996)  
Vert. Datum: NAVD 1988  
US Survey Feet  
**2005**

Point Name: **531**

**Designation:** 2005-531 Kossuth Co GPS Control Point

Northing: **3969203.61**sft Easting: **4686306.49**sft

Orthometric Height: **1208.55**sft Ellipsoid Height: **1115.35**sft **Geoid03**

Latitude: **43°23'07.69980"N** Longitude: **94°23'01.53552"W**

Mapping Angle: **-0°35'56"** Combination Scale Factor: **0.999970660**

**Monument Type:** Berntsen Top Security Rod Monument with a 2-1/2" dia. domed survey cap and permanent magnet encased in a 6"dia. PVC pipe with a NGS style aluminum access cover.

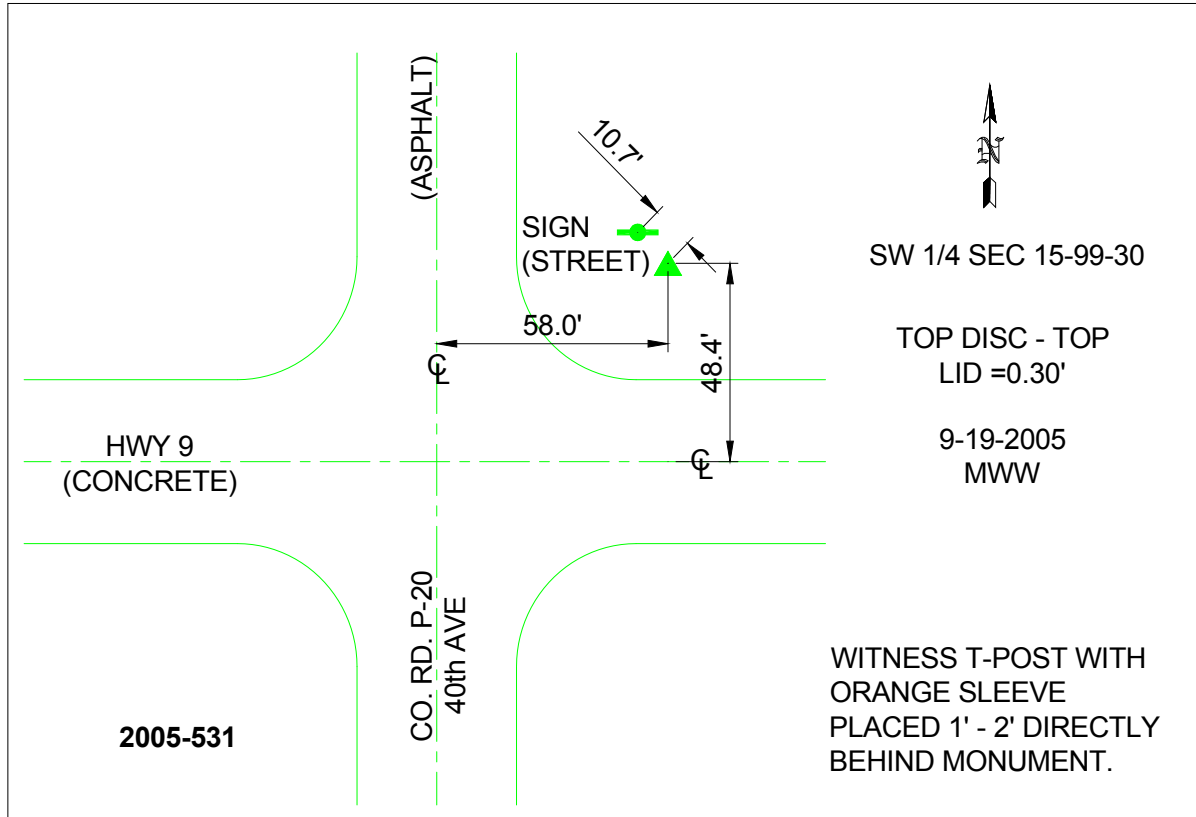

*This document was prepared by DCI and GBC for use by Kossuth County, Iowa.*