

Kossuth County, Iowa
Iowa North Zone (1401)
Horiz. Datum: NAD83(1996)
Vert. Datum: NAVD 1988
US Survey Feet
2005

Point Name: **556**

Designation: 2005-556 Kossuth Co GPS Control Point

Northing: **3905462.82sft** Easting: **4780005.63sft**

Orthometric Height: **1168.60sft** Ellipsoid Height: **1073.42sft** **Geoid03**

Latitude: **43°12'45.91560"N** Longitude: **94°01'47.32444"W**

Mapping Angle: **-0°21'33"** Combination Scale Factor: **0.999939380**

Monument Type: Berntsen Top Security Rod Monument with a 2-1/2" dia. domed survey cap and permanent magnet encased in a 6"dia. PVC pipe with a NGS style aluminum access cover.

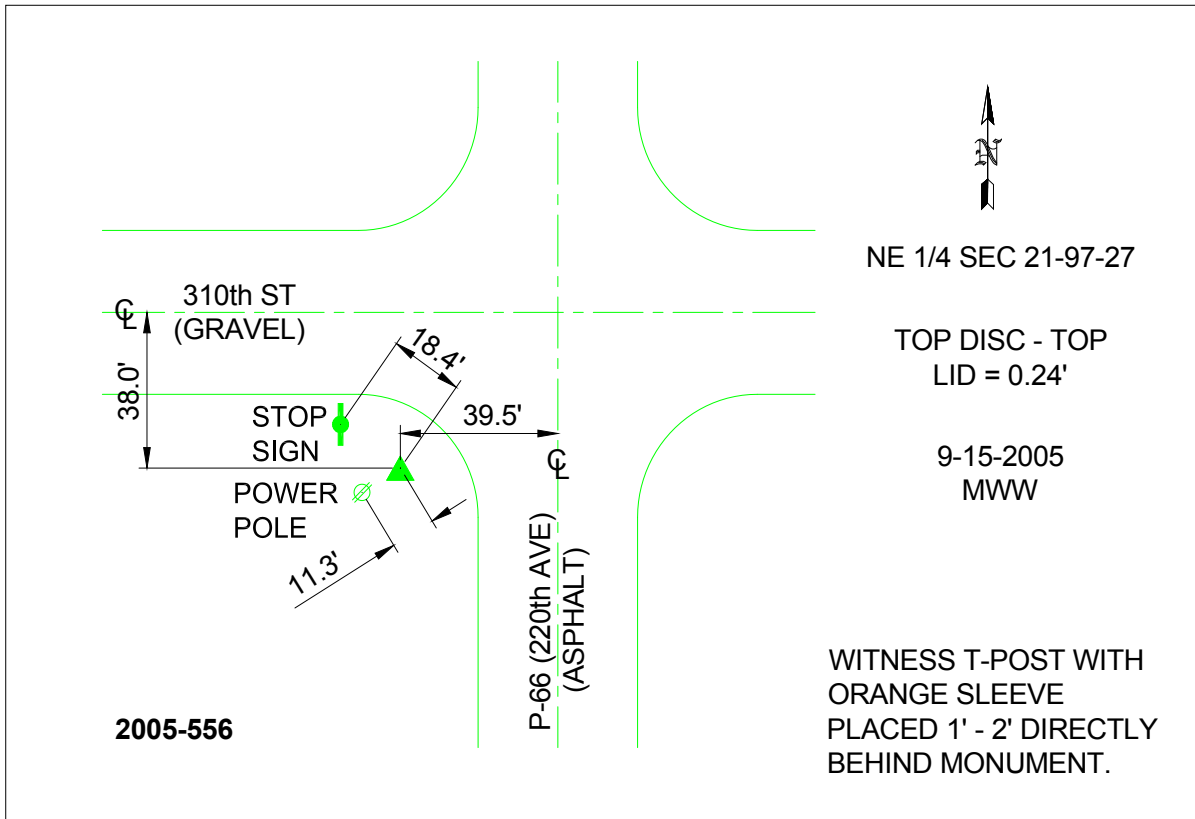

This document was prepared by DCI and GBC for use by Kossuth County, Iowa.