

Kossuth County, Iowa
Iowa North Zone (1401)
Horiz. Datum: NAD83(1996)
Vert. Datum: NAVD 1988
US Survey Feet
2005

Point Name: **590**

Designation: 2005-590 Kossuth Co GPS Control Point

Northing: **3842757.28sft** Easting: **4684483.54sft**

Orthometric Height: **1179.48sft** Ellipsoid Height: **1085.10sft** **Geoid03**

Latitude: **43°02'18.68385"N** Longitude: **94°23'08.28215"W**

Mapping Angle: **-0°36'01"** Combination Scale Factor: **0.999914510**

Monument Type: Berntsen Top Security Rod Monument with a 2-1/2" dia. domed survey cap and permanent magnet encased in a 6"dia. PVC pipe with a NGS style aluminum access cover.

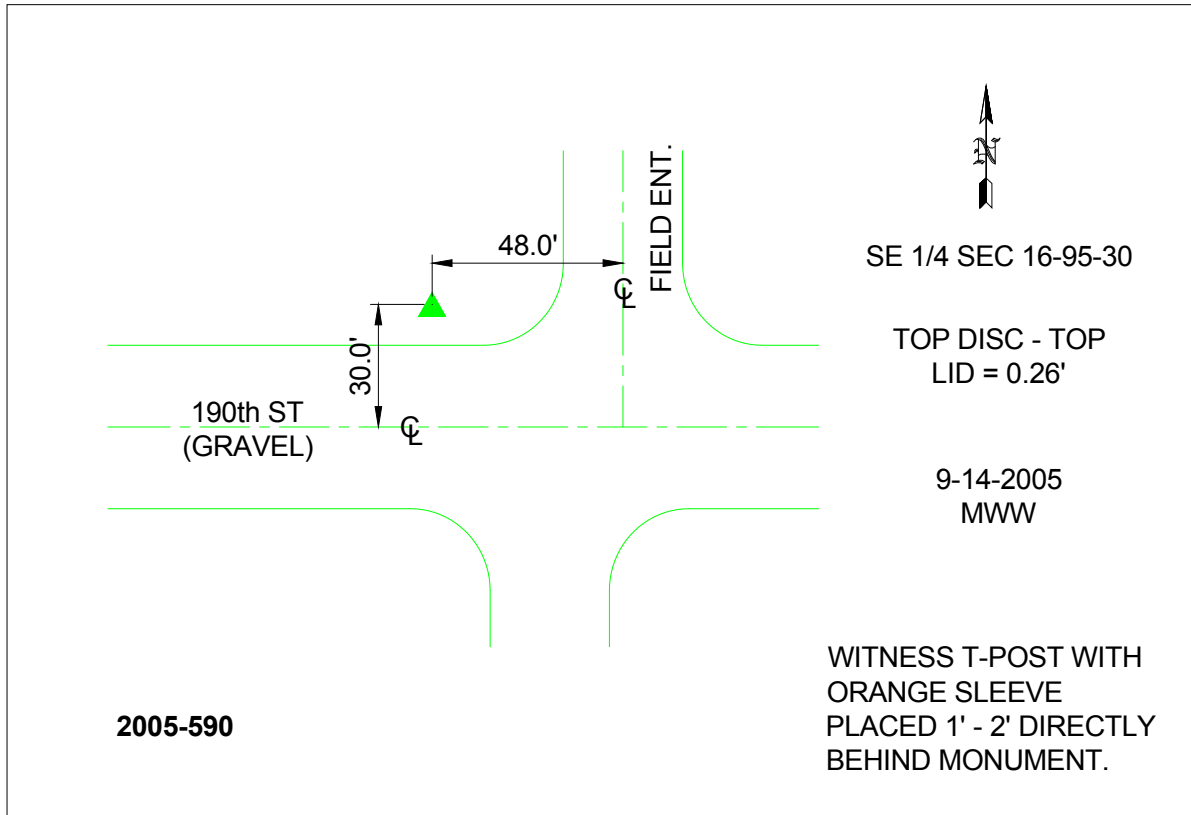

This document was prepared by DCI and GBC for use by Kossuth County, Iowa.