

Kossuth County, Iowa
 Iowa North Zone (1401)
 Horiz. Datum: NAD83(1996)
 Vert. Datum: NAVD 1988
 US Survey Feet
2005

Point Name: **617**

Designation: 2005-617 Kossuth Co GPS Control Point

Northing: **3861197.62sft** Easting: **4724474.48sft**

Orthometric Height: **1184.14sft** Ellipsoid Height: **1089.37sft** **Geoid03**

Latitude: **43°05'24.60751"N** Longitude: **94°14'11.96034"W**

Mapping Angle: **-0°29'57"** Combination Scale Factor: **0.999920550**

Monument Type: Berntsen Top Security Rod Monument with a 2-1/2" dia. domed survey cap and permanent magnet encased in a 6"dia. PVC pipe with a NGS style aluminum access cover.

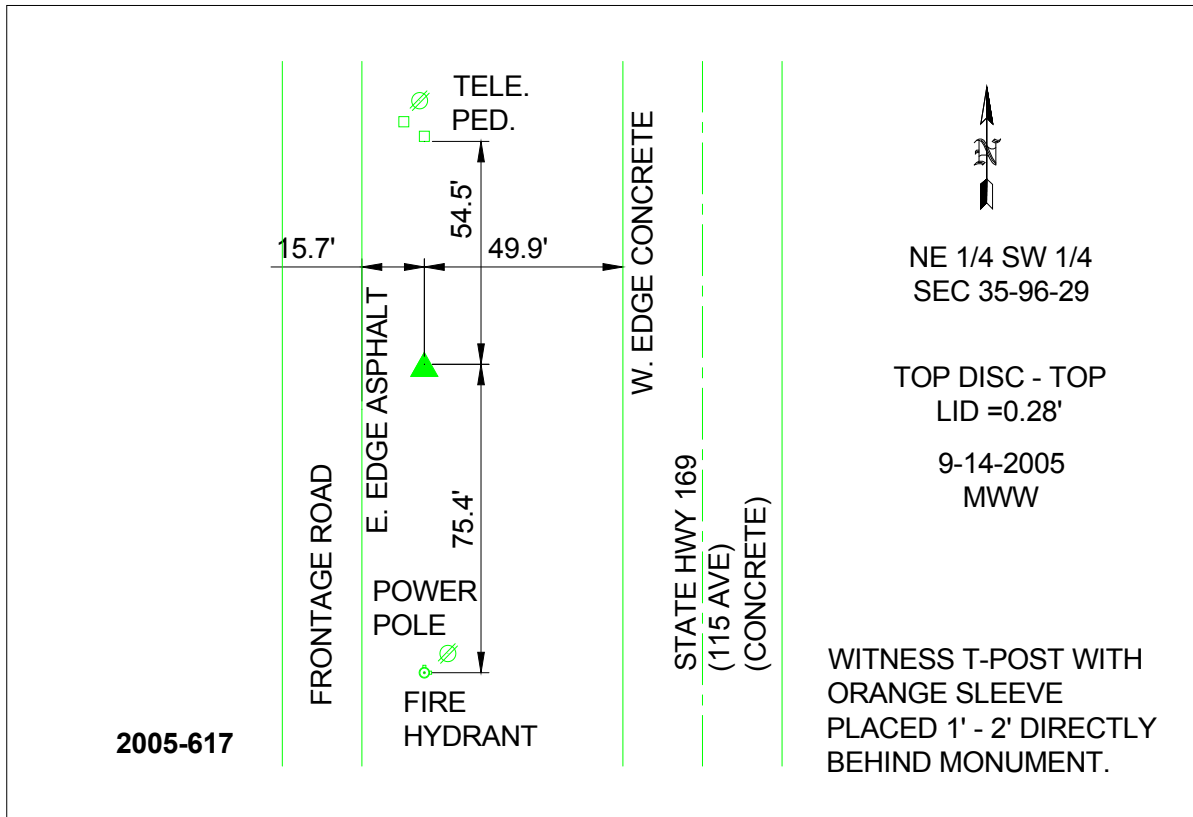

This document was prepared by DCI and GBC for use by Kossuth County, Iowa.