

Kossuth County, Iowa
Iowa North Zone (1401)
Horiz. Datum: NAD83(1996)
Vert. Datum: NAVD 1988
US Survey Feet
2005

Point Name: **619**

Designation: 2005-619 Kossuth Co GPS Control Point

Northing: **3847570.54sft** Easting: **4726825.06sft**

Orthometric Height: **1144.90sft** Ellipsoid Height: **1049.89sft** **Geoid03**

Latitude: **43°03'10.21427"N** Longitude: **94°13'38.70279"W**

Mapping Angle: **-0°29'35"** Combination Scale Factor: **0.999917840**

Monument Type: Berntsen Top Security Rod Monument with a 2-1/2" dia. domed survey cap and permanent magnet encased in a 6"dia. PVC pipe with a NGS style aluminum access cover.

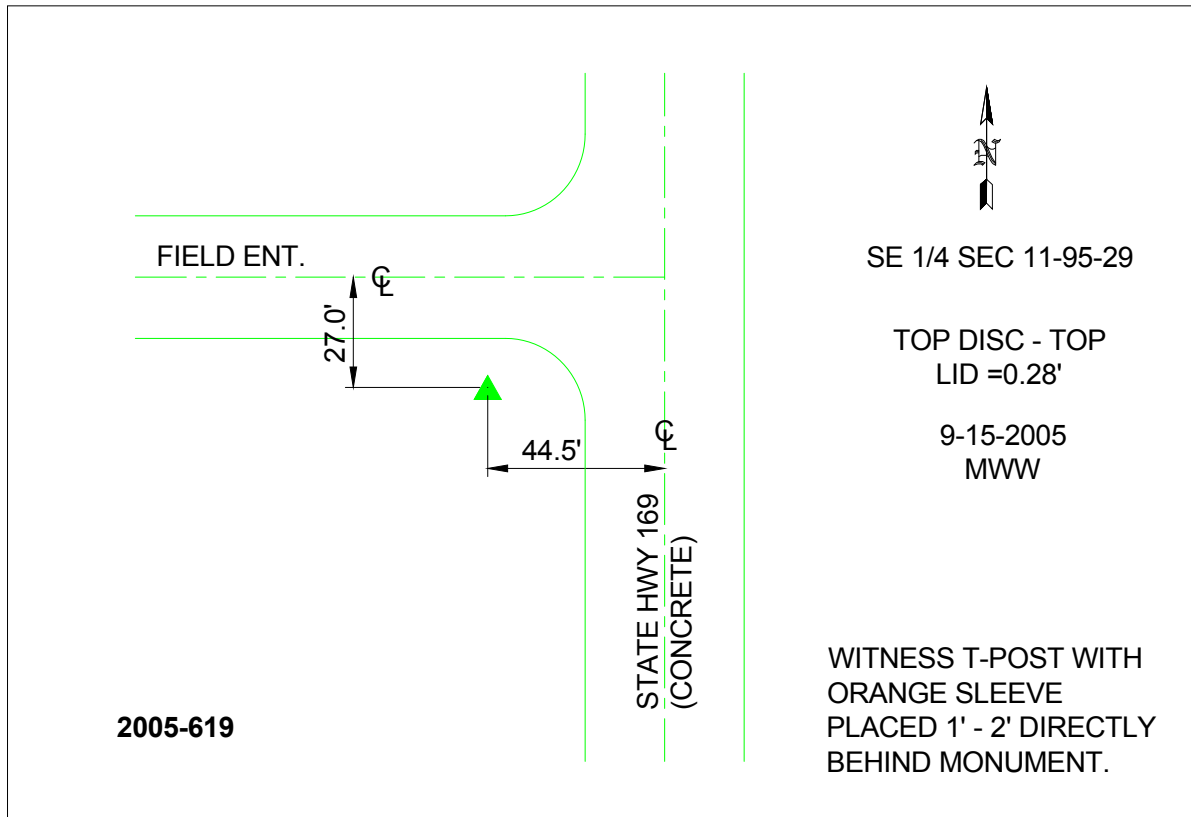

This document was prepared by DCI and GBC for use by Kossuth County, Iowa.