

Kossuth County, Iowa
Iowa North Zone (1401)
Horiz. Datum: NAD83(1996)
Vert. Datum: NAVD 1988
US Survey Feet
2005

Point Name: **620**

Designation: 2005-620 Kossuth Co GPS Control Point

Northing: **3852496.10sft** Easting: **4731955.85sft**

Orthometric Height: **1202.46sft** Ellipsoid Height: **1107.43sft** **Geoid03**

Latitude: **43°03'59.29445"N** Longitude: **94°12'30.15557"W**

Mapping Angle: **-0°28'48"** Combination Scale Factor: **0.999916720**

Monument Type: Berntsen Top Security Rod Monument with a 2-1/2" dia. domed survey cap and permanent magnet encased in a 6"dia. PVC pipe with a NGS style aluminum access cover.

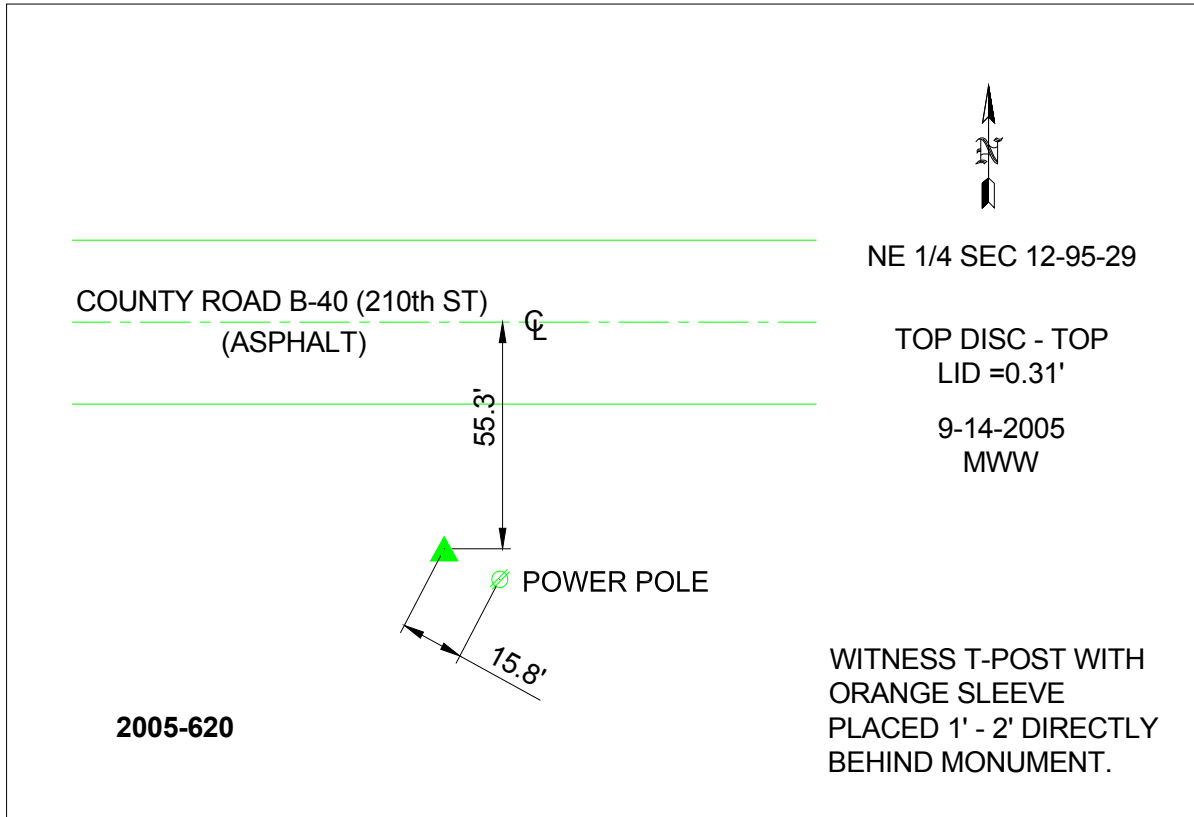

This document was prepared by DCI and GBC for use by Kossuth County, Iowa.