

Kossuth County, Iowa
Iowa North Zone (1401)
Horiz. Datum: NAD83(1996)
Vert. Datum: NAVD 1988
US Survey Feet
2005

Point Name: **624**

Designation: 2005-624 Kossuth Co GPS Control Point

Northing: **3935085.50**sft Easting: **4726490.47**sft

Orthometric Height: **1165.99**sft Ellipsoid Height: **1072.12**sft **Geoid03**

Latitude: **43°17'34.54081"N** Longitude: **94°13'53.40835"W**

Mapping Angle: **-0°29'45"** Combination Scale Factor: **0.999953750**

Monument Type: Berntsen Top Security Rod Monument with a 2-1/2" dia. domed survey cap and permanent magnet encased in a 6"dia. PVC pipe with a NGS style aluminum access cover.

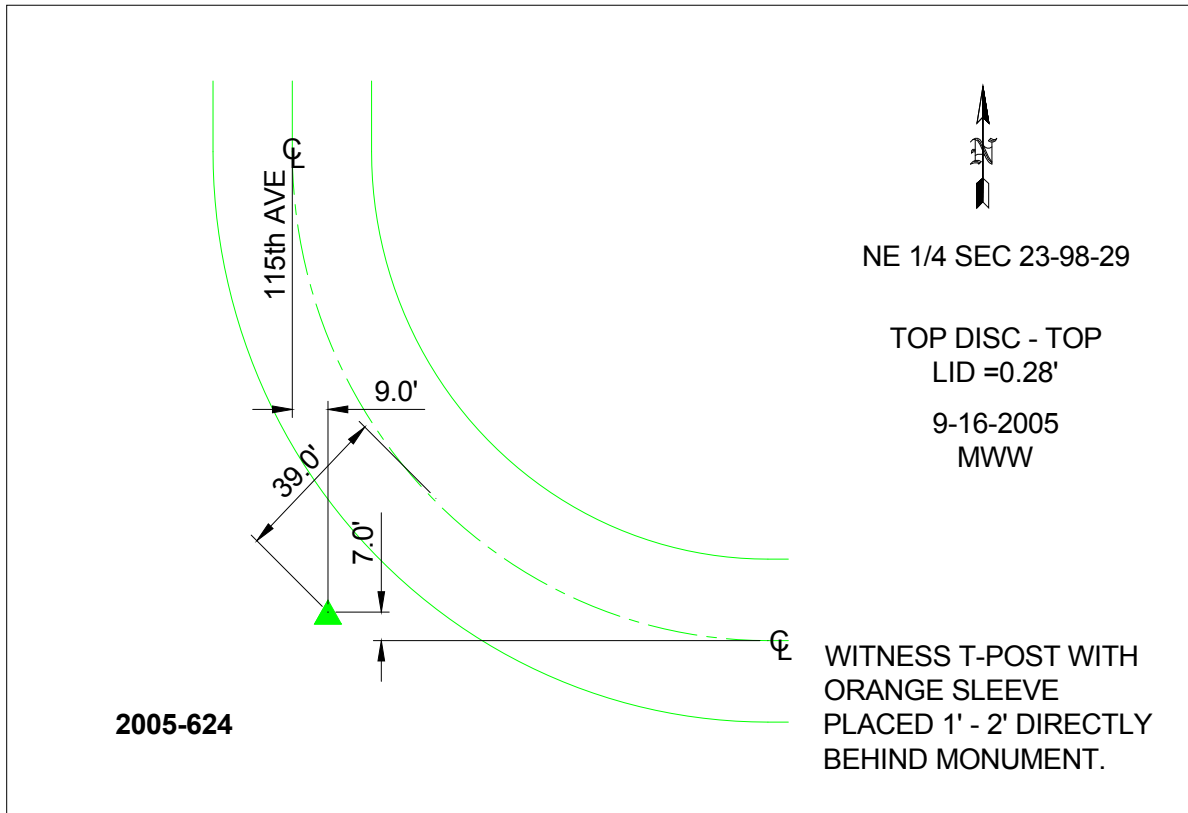

This document was prepared by DCI and GBC for use by Kossuth County, Iowa.