

Kossuth County, Iowa
Iowa North Zone (1401)
Horiz. Datum: NAD83(1996)
Vert. Datum: NAVD 1988
US Survey Feet
2005

Point Name: **626**

Designation: 2005-626 Kossuth Co GPS Control Point

Northing: **3979245.81**sft Easting: **4743603.64**sft

Orthometric Height: **1136.66**sft Ellipsoid Height: **1043.25**sft **Geoid03**

Latitude: **43°24'52.06982"N** Longitude: **94°10'06.74737"W**

Mapping Angle: **-0°27'11"** Combination Scale Factor: **0.999980580**

Monument Type: Berntsen Top Security Rod Monument with a 2-1/2" dia. domed survey cap and permanent magnet encased in a 6"dia. PVC pipe with a NGS style aluminum access cover.

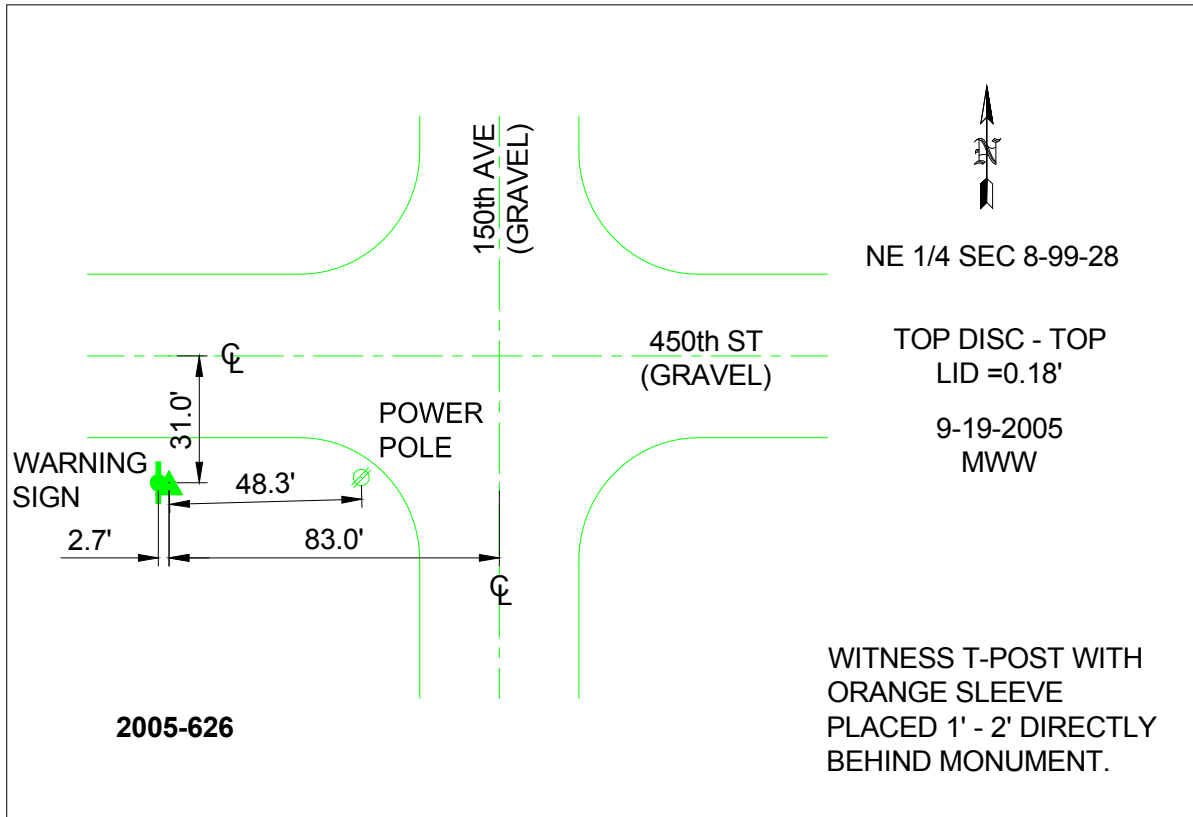

This document was prepared by DCI and GBC for use by Kossuth County, Iowa.