

Kossuth County, Iowa
Iowa North Zone (1401)
Horiz. Datum: NAD83(1996)
Vert. Datum: NAVD 1988
US Survey Feet
2005

Point Name: **628**

Designation: 2005-628 Kossuth Co GPS Control Point

Northing: **3910813.88sft** Easting: **4774889.19sft**

Orthometric Height: **1157.14sft** Ellipsoid Height: **1062.14sft** **Geoid03**

Latitude: **43°13'38.44376"N** Longitude: **94°02'56.88280"W**

Mapping Angle: **-0°22'20"** Combination Scale Factor: **0.999942380**

Monument Type: Berntsen Top Security Rod Monument with a 2-1/2" dia. domed survey cap and permanent magnet encased in a 6"dia. PVC pipe with a NGS style aluminum access cover.

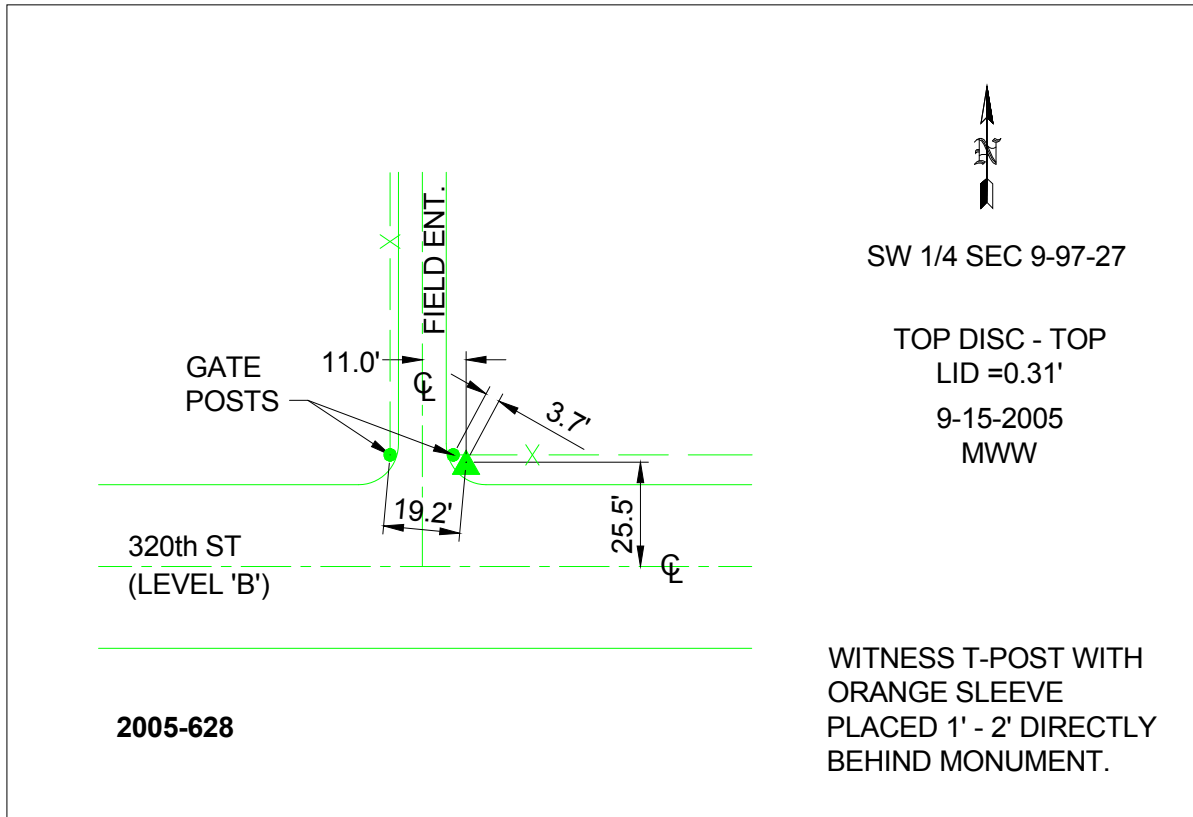

This document was prepared by DCI and GBC for use by Kossuth County, Iowa.