

2001
Lee County, Iowa
Iowa South Zone (1402)
NAD_83(1996)

Point Number: 1

Northing: 206419.94(Ft) Easting: 2152488.22(Ft)

Northing: 62916.923(M) Easting: 656079.721(M)

Elev: 539.70(Ft) NAVD_88

Elev: 164.533(M) NAVD_88 Ellip Ht: 131.364(M) 96C Geoid Ht: -33.170(M)

Latitude: 40-33-06.049110 N Longitude: 91-39-25.945069 W

Theta: 1-12-49.86 Combination Factor: 0.99999149

Designation: LEE CO GPS CONTROL PT 2001-001

Monument Type: 5/8" dia driven aluminum rod with a 2-1/2" dia aluminum cap and permanent magnet encased in a 5" dia PVC pipe with an aluminum access cover.

Remarks: 35ft N of Belfast Rd, 20ft W of pvt dr #2826 to N near section line in the NW 1/4 of Sec 3 T66N R7W.

Date Printed June 22, 2001

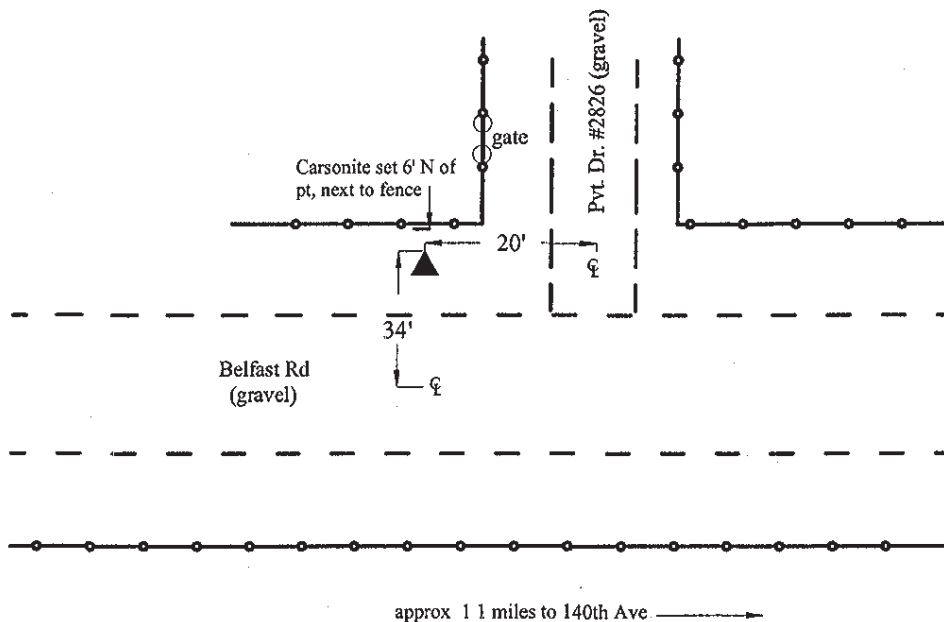

2001-001

BRS/RKE/SBS
March 6, 2001

Set NGS style rod
monument with
access cover