

2001
Lee County, Iowa
Iowa South Zone (1402)
NAD_83(1996)

Point Number: 4

Northing: 254143.41(Ft) Easting: 2150430.55(Ft)

Northing: 77463.066(M) Easting: 655452.542(M)

Elev: 717.59(Ft) NAVD_88

Elev: 218.744(M) NAVD_88 Ellip Ht: 185.573(M) 96C Geoid Ht: -33.172(M)

Latitude: 40-40-57.942909 N Longitude: 91-39-39.525127 W

Theta: 1-12-40.91 Combination Factor: 0.99995987

Designation: LEE CO GPS CONTROL PT 2001-004

Monument Type: 5/8" dia driven aluminum rod with a 2-1/2" dia aluminum cap and permanent magnet encased in a 5" dia PVC pipe with an aluminum access cover.

Remarks: 40ft N of 190th St., 45ft E of 130th Ave near the NW Cor of Sec 22 T68N R7W.

Date Printed June 22, 2001

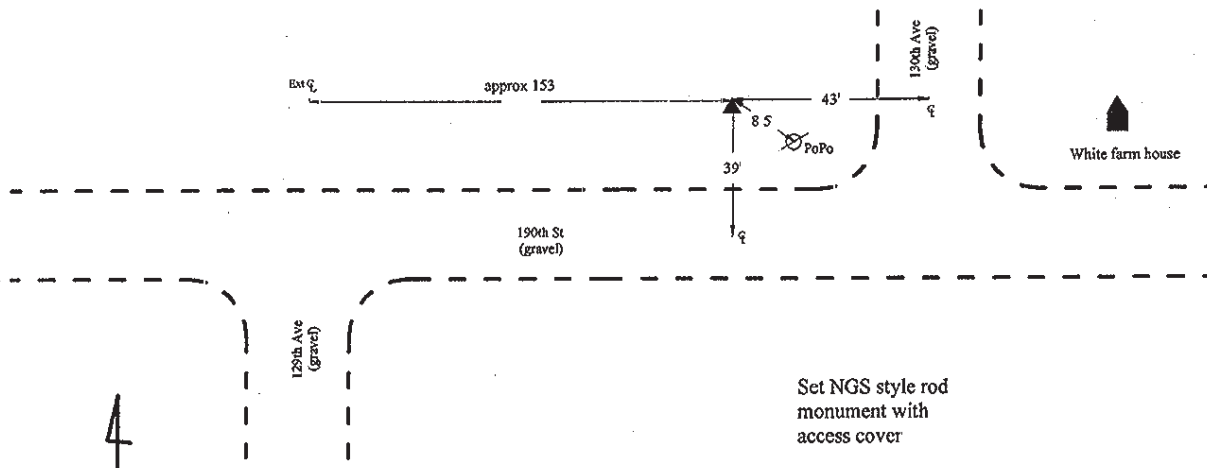

2001-004
BRS/RKE/SBS
March 6, 2001