

2001
Lee County, Iowa
Iowa South Zone (1402)
NAD_83(1996)

Point Number: 10

Northing: 223949.74(Ft) Easting: 2167804.70(Ft)

Northing: 68260.015(M) Easting: 660748.195(M)

Elev: 662.65(Ft) NAVD_88

Elev: 201.991(M) NAVD_88 Ellip Ht: 168.794(M) 96C Geoid Ht: -33.197(M)

Latitude: 40-35-55.970612 N Longitude: 91-36-02.619075 W

Theta: 1-15-03.79 Combination Factor: 0.99997670

Designation: LEE CO GPS CONTROL PT 2001-010

Monument Type: 5/8" dia driven aluminum rod with a 2-1/2" dia aluminum cap and permanent magnet encased in a 5" dia PVC pipe with an aluminum access cover.

Remarks: 0.45 mi S of 245th St., 20ft E of 160th Ave near the SW Cor of Sec 18 T67N R6W.

Date Printed June 22, 2001

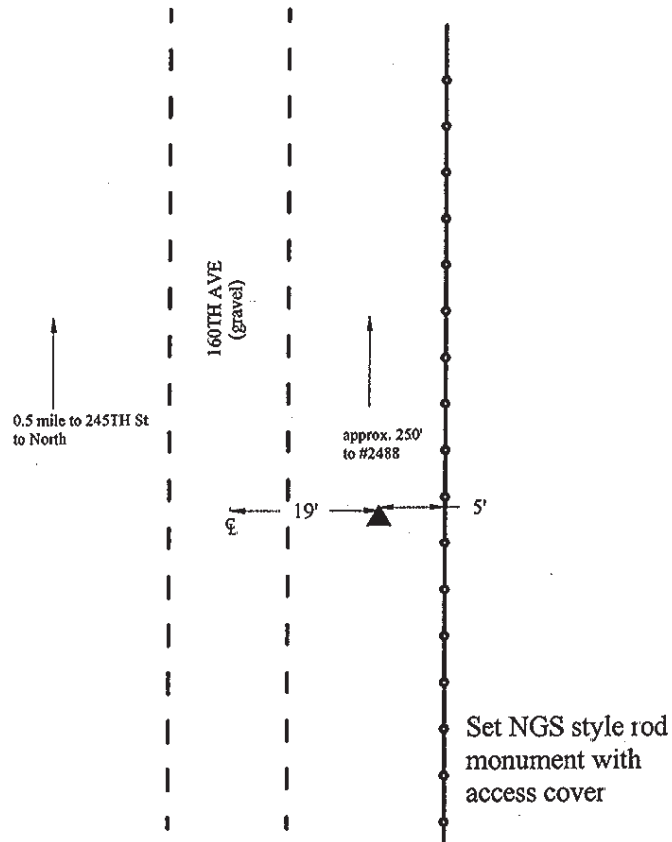

4
2001-010
BRS/RKE/SBS
March 6, 2001