

2001
Lee County, Iowa
Iowa South Zone (1402)
NAD_83(1996)

Point Number: 19

Northing: 223808.32(Ft) Easting: 2182982.32(Ft)

Northing: 68216.911(M) Easting: 665374.343(M)

Elev: 693.06(Ft) NAVD_88

Elev: 211.254(M) NAVD_88 Ellip Ht: 178.037(M) 96C Geoid Ht: -33.217(M)

Latitude: 40-35-51.252067 N Longitude: 91-32-45.953568 W

Theta: 1-17-13.33 Combination Factor: 0.99997549

Designation: LEE CO GPS CONTROL PT 2001-019

Monument Type: 5/8" dia driven aluminum rod with a 2-1/2" dia aluminum cap and permanent magnet encased in a 5" dia PVC pipe with an aluminum access cover.

Remarks: 150ft W of section line fence to N, 30ft N of 250th St, 0.35 mi W of Hwy 218 near the SE Cor of Sec 16 T67N R6W.

Date Printed June 22, 2001

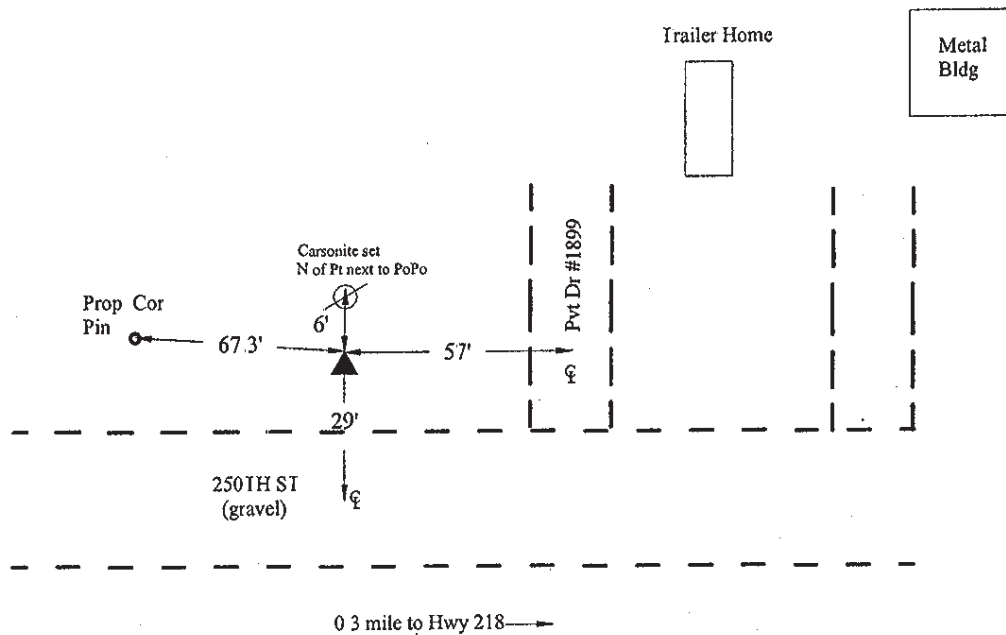

2001-019

BRS/RKE/SBS

March 7, 2001

Set NGS style rod
monument with
access cover