

2001
Lee County, Iowa
Iowa South Zone (1402)
NAD_83(1996)

Point Number: 57

Northing: 271858.87(Ft) Easting: 2248582.44(Ft)

Northing: 82862.750(M) Easting: 685369.298(M)

Elev: 677.68(Ft) NAVD_88

Elev: 206.559(M) NAVD_88 Ellip Ht: 173.332(M) 96C Geoid Ht: -33.227(M)

Latitude: 40-43-30.463056 N Longitude: 91-18-20.114680 W

Theta: 1-26-43.66 Combination Factor: 0.99995543

Designation: LEE CO GPS CONTROL PT 2001-057

Monument Type: 5/8" dia driven aluminum rod with a 2-1/2" dia aluminum cap and permanent magnet encased in a 5" dia PVC pipe with an aluminum access cover.

Remarks: 25ft S of 160th St., approx. 150ft from dead end of 160th St. to W near the N 1/4 Cor of Sec 3 T68N R4W.

Date Printed June 22, 2001

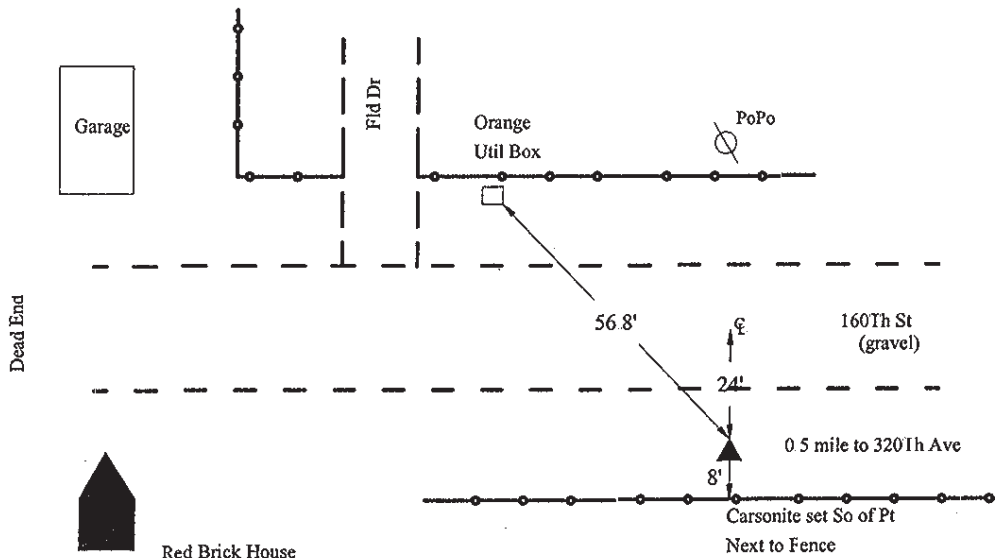

2001-057
BRS/RKE/SBS
March 8, 2001

Set NGS style rod
monument with
access cover