

2001  
Lee County, Iowa  
Iowa South Zone (1402)  
NAD\_83(1996)

Point Number: 61

Northing: 272177.98(Ft)      Easting: 2264420.71(Ft)

Northing: 82960.013(M)      Easting: 690196.814(M)

Elev: 668.57(Ft) NAVD\_88

Elev: 203.780(M) NAVD\_88      Ellip Ht: 170.545(M)      96C Geoid Ht: -33.235(M)

Latitude: 40-43-29.615947 N      Longitude: 91-14-54.363817 W

Theta: 1-28-59.19      Combination Factor: 0.99995590

Designation: LEE CO GPS CONTROL PT 2001-061

**Monument Type:** 5/8" dia driven aluminum rod with a 2-1/2" dia aluminum cap and permanent magnet encased in a 5" dia PVC pipe with an aluminum access cover.

**Remarks:** 25ft W of 345th Ave, 50ft S of section line fence near the N 1/4 Cor of Sec 6 T68N R3W.

Date Printed June 22, 2001

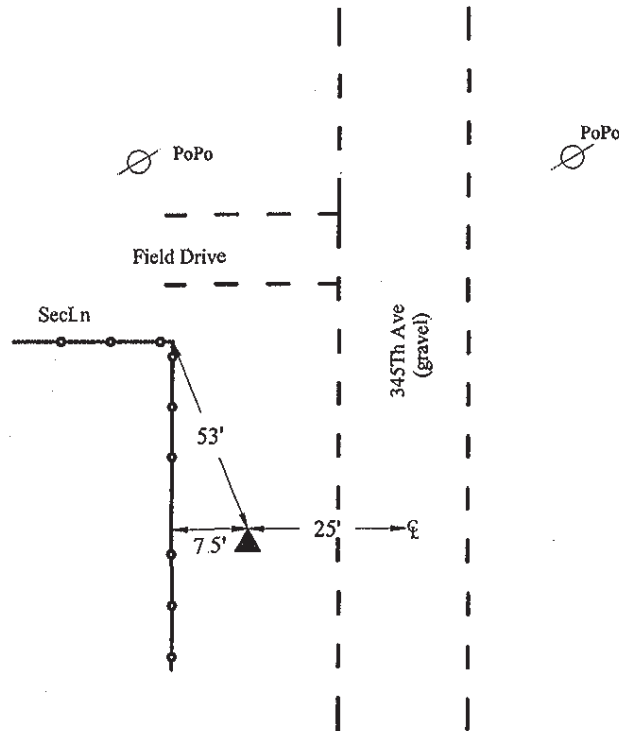

2001-061  
BRS/RKE/SBS  
March 8, 2001

Set NGS style rod  
monument with  
access cover