

2001
Lee County, Iowa
Iowa South Zone (1402)
NAD_83(1996)

Point Number: 142

Northing: 250998.67(Ft) Easting: 2263337.67(Ft)

Northing: 76504.548(M) Easting: 689866.701(M)

Elev: 551.64(Ft) NAVD_88

Elev: 168.140(M) NAVD_88 Ellip Ht: 134.893(M) 96C Geoid Ht: -33.247(M)

Latitude: 40-40-00.683916 N Longitude: 91-15-15.527168 W

Theta: 1-28-45.25 Combination Factor: 0.99997035

Designation: LEE CO GPS CONTROL PT 2001-142

Monument Type: 5/8" dia driven aluminum rod with a 2-1/2" dia aluminum cap and permanent magnet encased in a 5" dia PVC pipe with an aluminum access cover.

Remarks: 20ft SE of 343rd Ave, 5ft NE of field drv to SE, approx. 0.25 mi SW from 190th St. (J 50) the SW 1/4 of Sec 19 T68N R3W.

Date Printed June 22, 2001

2001-142
RKE/SBS
March 14, 2001

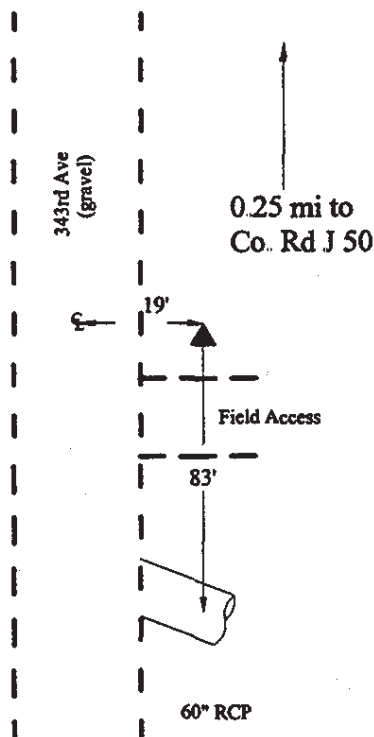

Set NGS style rod
monument with
access cover