

Lee County, Iowa

Horizontal Datum: **NAD 83(2011)** - Vertical Datum: **NAVD 1988**
Iowa State Plane South Zone (1402)
Iowa Regional Coordinate System Zone 14 Burlington
US Survey Feet
2014

Point Name: **1**

Designation: Lee Co. GPS Control Pt. 2001-001 (Set by ASI in 2001)

NAD 83(NA2011) Latitude: **N40°33'06.04955"** Longitude: **W91°39'25.94287"**
NAVD 88 Ortho Height: **539.700sft** Ellip. Ht: **430.769sft** **Geoid12A**

Iowa South Zone (1402) Northing: **206419.987sft** Easting: **2152488.387sft**
Mapping Angle: **1°12'50"** Combination Scale Factor: **0.9999915483**

IaRCS Zone 14 Northing: **6310169.049sft** Easting: **24386837.052sft**
Mapping Angle: **-0°15'53"** Combination Scale Factor: **1.0000120809**

Monument Type: 5/8" dia. driven aluminum rod with a 2-1/2" dia. aluminum cap and permanent magnet encased in a 5" dia. PVC pipe with an aluminum access cover.

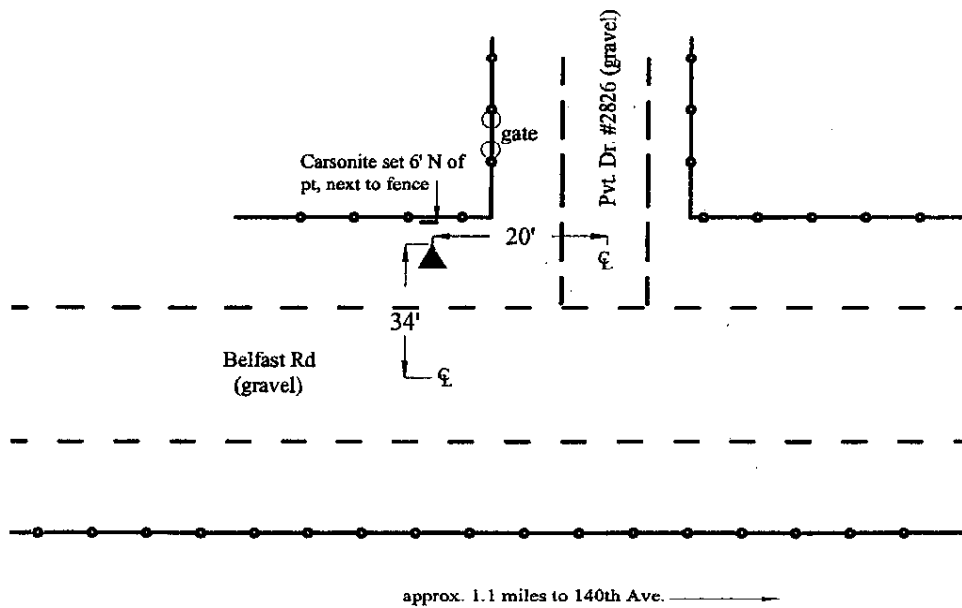

4

2001-001
BRS/RKE/SBS
March 6, 2001

**Set NGS style rod
monument with
access cover**

This document was prepared by DCI on December 17, 2014 for use by Lee County, Iowa