

Lee County, Iowa

Horizontal Datum: **NAD 83(2011)** - Vertical Datum: **NAVD 1988**
Iowa State Plane South Zone (1402)
Iowa Regional Coordinate System Zone 14 Burlington
US Survey Feet
2014

Point Name: **2**

Designation: Lee Co. GPS Control Pt. 2001-002 (Set by ASI in 2001)

NAD 83(NA2011) Latitude: **N40°35'54.38047"** Longitude: **W91°39'28.26302"**
NAVD 88 Ortho Height: **710.480sft** Ellip. Ht: **601.557sft** **Geoid12A**

Iowa South Zone (1402) Northing: **223447.706sft** Easting: **2151948.574sft**
Mapping Angle: **1°12'48"** Combination Scale Factor: **0.9999745611**

IaRCS Zone 14 Northing: **6327205.454sft** Easting: **24386736.826sft**
Mapping Angle: **-0°15'55"** Combination Scale Factor: **1.0000039568**

Monument Type: 5/8" dia. driven aluminum rod with a 2-1/2" dia. aluminum cap and permanent magnet encased in a 5" dia. PVC pipe with an aluminum access cover.

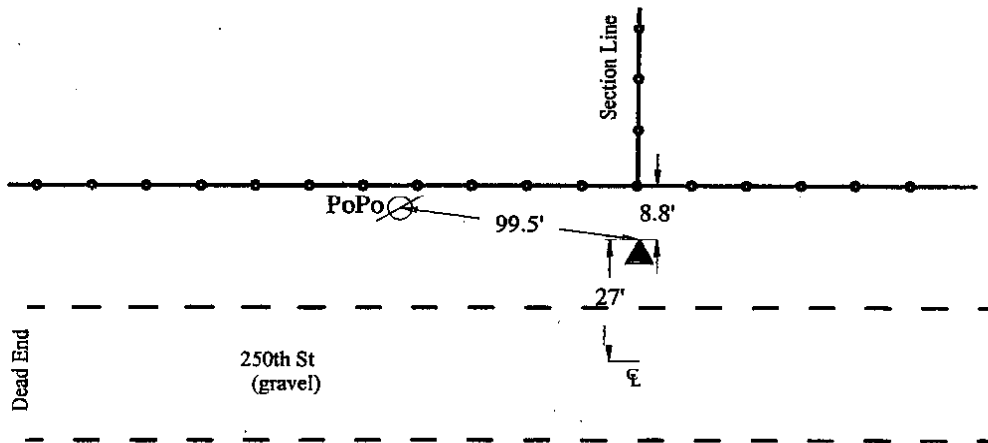

4
2001-002
BRS/RKE/SBS
March 6, 2001

Set NGS style rod
monument with
access cover