

Lee County, Iowa

Horizontal Datum: **NAD 83(2011)** - Vertical Datum: **NAVD 1988**
Iowa State Plane South Zone (1402)
Iowa Regional Coordinate System Zone 14 Burlington
US Survey Feet
2014

Point Name: **3**

Designation: Lee Co. GPS Control Pt. 2001-003 (Set by ASI in 2001)

NAD 83(NA2011) Latitude: **N40°37'54.64234"** Longitude: **W91°39'53.60580"**
NAVD 88 Ortho Height: **712.280sft** Ellip. Ht: **603.377sft** **Geoid12A**

Iowa South Zone (1402) Northing: **235574.349sft** Easting: **2149737.327sft**
Mapping Angle: **1°12'32"** Combination Scale Factor: **0.9999685632**

laRCS Zone 14 Northing: **6339385.524sft** Easting: **24384839.228sft**
Mapping Angle: **-0°16'13"** Combination Scale Factor: **1.0000043653**

Monument Type: 5/8" dia. driven aluminum rod with a 2-1/2" dia. aluminum cap and permanent magnet encased in a 5" dia. PVC pipe with an aluminum access cover.

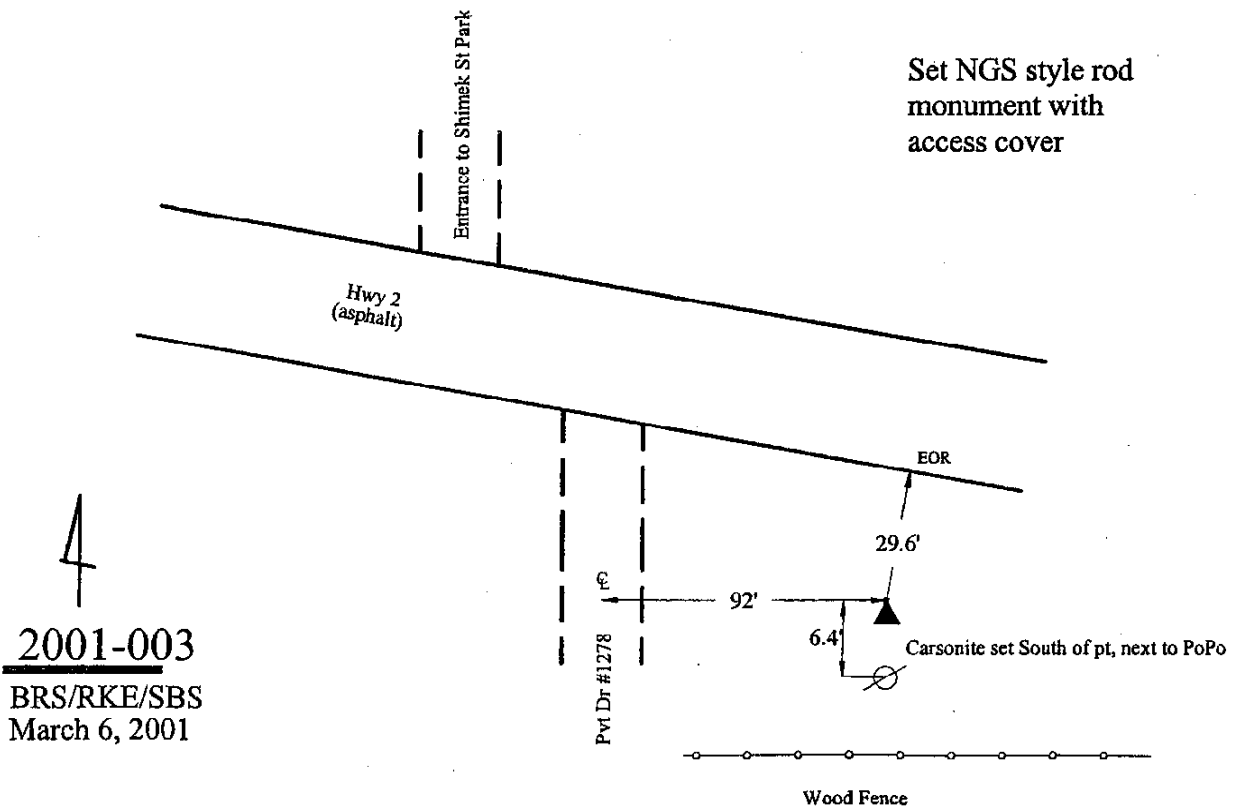

This document was prepared by DCI on December 17, 2014 for use by Lee County, Iowa