

Lee County, Iowa

Horizontal Datum: **NAD 83(2011)** - Vertical Datum: **NAVD 1988**
Iowa State Plane South Zone (1402)
Iowa Regional Coordinate System Zone 14 Burlington
US Survey Feet
2014

Point Name: **8**

Designation: Lee Co. GPS Control Pt. 2001-008 (Set by ASI in 2001)

NAD 83(NA2011) Latitude: **N40°30'55.73939"** Longitude: **W91°36'07.51820"**
NAVD 88 Ortho Height: **680.710sft** Ellip. Ht: **571.730sft** **Geoid12A**

Iowa South Zone (1402) Northing: **193564.869sft** Easting: **2168089.780sft**
Mapping Angle: **1°15'01"** Combination Scale Factor: **0.9999921143**

IaRCS Zone 14 Northing: **6296915.403sft** Easting: **24402101.740sft**
Mapping Angle: **-0°13'43"** Combination Scale Factor: **1.0000016717**

Monument Type: 5/8" dia. driven aluminum rod with a 2-1/2" dia. aluminum cap and permanent magnet encased in a 5" dia. PVC pipe with an aluminum access cover.

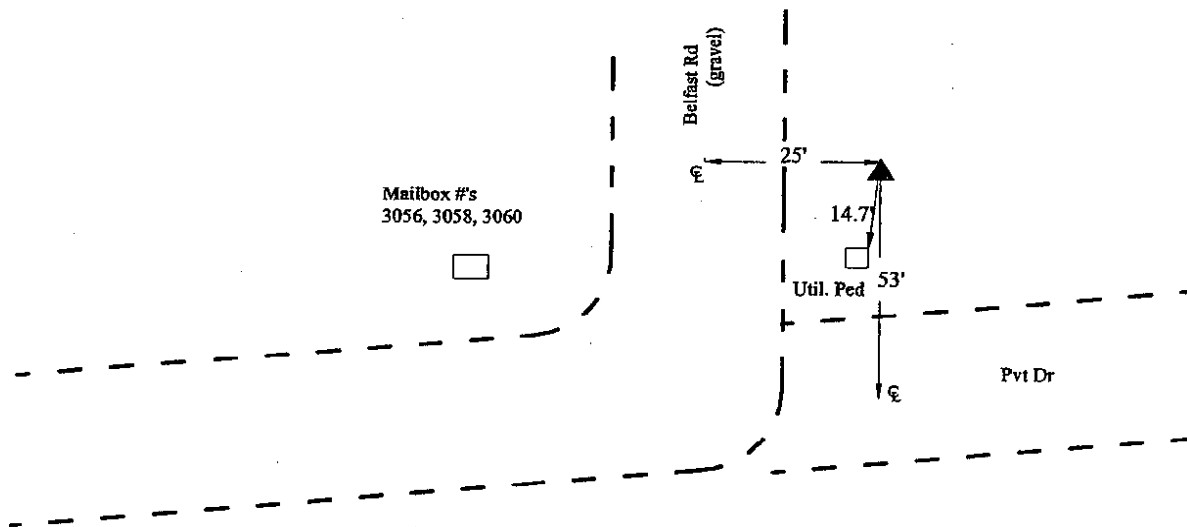

4

2001-008
BRS/RKE/SBS
March 9, 2001

Set NGS style rod
monument with
access cover

This document was prepared by DCI on December 17, 2014 for use by Lee County, Iowa