

Lee County, Iowa

Horizontal Datum: **NAD 83(2011)** - Vertical Datum: **NAVD 1988**
Iowa State Plane South Zone (1402)
Iowa Regional Coordinate System Zone 14 Burlington
US Survey Feet
2014

Point Name: **10**

Designation: Lee Co. GPS Control Pt. 2001-010 (Set by ASI in 2001)

NAD 83(NA2011) Latitude: **N40°35'55.97070"** Longitude: **W91°36'02.61660"**
NAVD 88 Ortho Height: **662.650sft** Ellip. Ht: **553.639sft** **Geoid12A**

Iowa South Zone (1402) Northing: **223949.746sft** Easting: **2167804.893sft**
Mapping Angle: **1°15'04"** Combination Scale Factor: **0.9999767673**

IaRCS Zone 14 Northing: **6327298.050sft** Easting: **24402601.256sft**
Mapping Angle: **-0°13'42"** Combination Scale Factor: **1.0000024234**

Monument Type: 5/8" dia. driven aluminum rod with a 2-1/2" dia. aluminum cap and permanent magnet encased in a 5" dia. PVC pipe with an aluminum access cover.

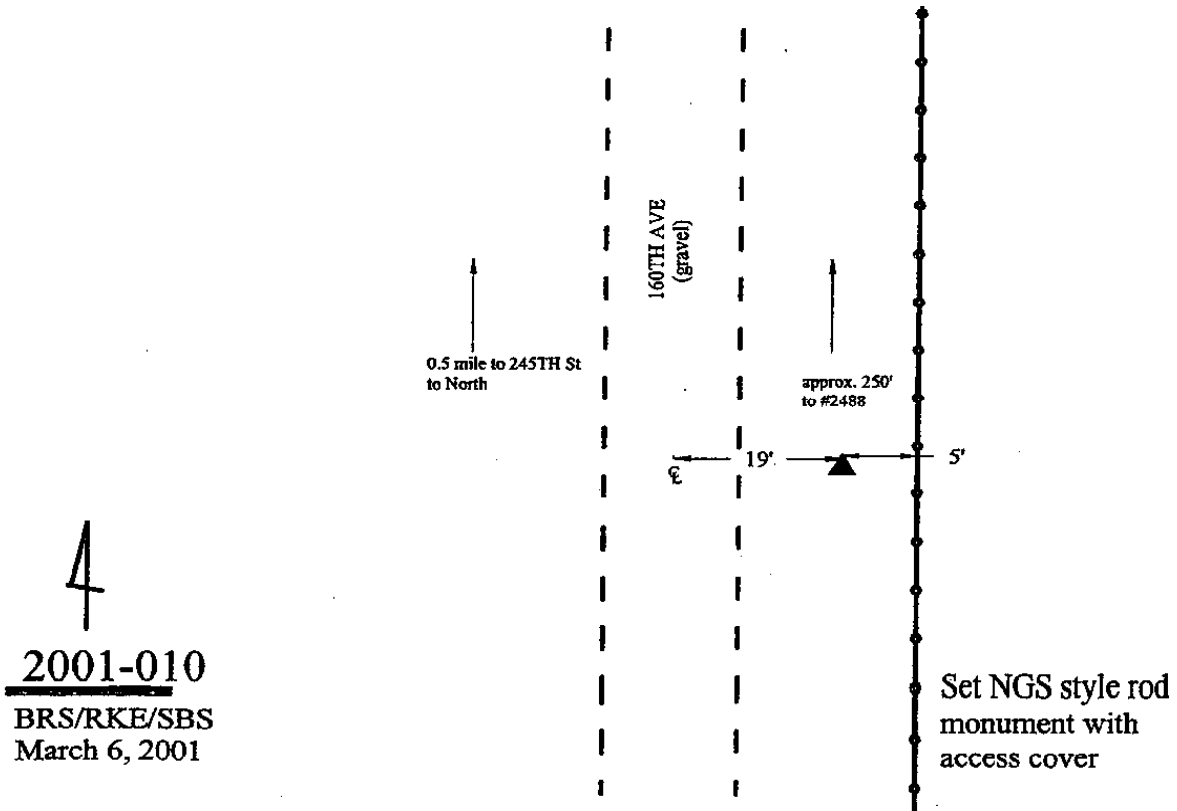

This document was prepared by DCI on December 17, 2014 for use by Lee County, Iowa