

Lee County, Iowa

Horizontal Datum: **NAD 83(2011)** - Vertical Datum: **NAVD 1988**

Iowa State Plane South Zone (1402)

Iowa Regional Coordinate System Zone 14 Burlington

US Survey Feet

2014

Point Name: **16**

Designation: Lee Co. GPS Control Pt. 2001-016 (Set by ASI in 2001)

NAD 83(NA2011) Latitude: **N40°27'56.91243"** Longitude: **W91°32'49.81383"**

NAVD 88 Ortho Height: **537.860sft** Ellip. Ht: **428.865sft** **Geoid12A**

Iowa South Zone (1402) Northing: **175809.813sft** Easting: **2183762.245sft**

Mapping Angle: **1°17'11"** Combination Scale Factor: **1.0000095800**

IaRCS Zone 14 Northing: **6278761.688sft** Easting: **24417310.745sft**

Mapping Angle: **-0°11'34"** Combination Scale Factor: **1.0000053498**

Monument Type: 5/8" dia. driven aluminum rod with a 2-1/2" dia. aluminum cap and permanent magnet encased in a 5" dia. PVC pipe with an aluminum access cover.

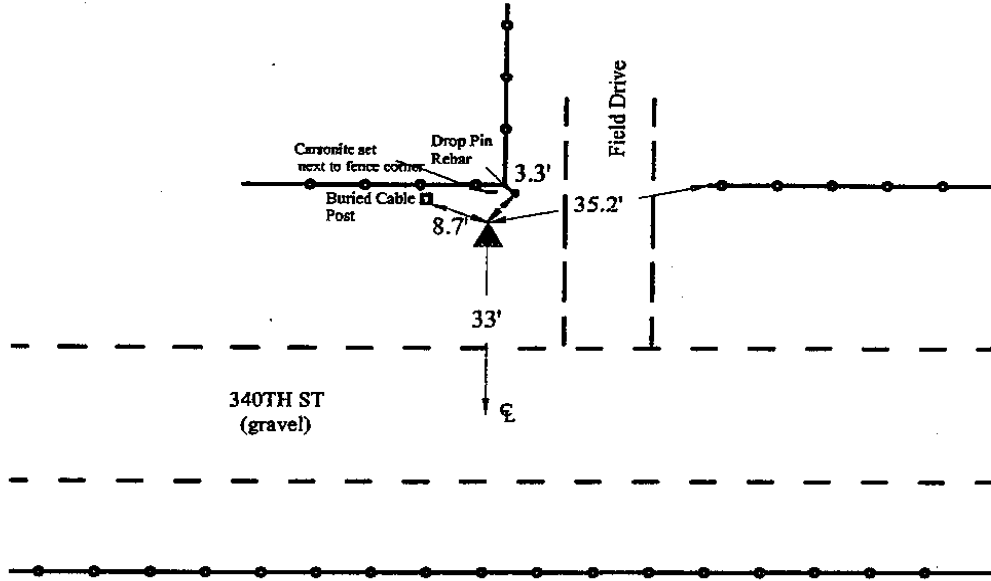

4

2001-016
BRS/RKE/SBS
March 6, 2001

Set NGS style rod
monument with
access cover

This document was prepared by DCI on December 17, 2014 for use by Lee County, Iowa