

**Lee County, Iowa**

Horizontal Datum: **NAD 83(2011)** - Vertical Datum: **NAVD 1988**  
Iowa State Plane South Zone (1402)  
Iowa Regional Coordinate System Zone 14 Burlington  
US Survey Feet  
**2014**

Point Name: **19**

**Designation:** Lee Co. GPS Control Pt. 2001-019 (Set by ASI in 2001)

NAD 83(NA2011) Latitude: **N40°35'51.25180"** Longitude: **W91°32'45.95159"**  
NAVD 88 Ortho Height: **693.060sft** Ellip. Ht: **583.986sft** **Geoid12A**

Iowa South Zone (1402) Northing: **223808.292sft** Easting: **2182982.475sft**  
Mapping Angle: **1°17'13"** Combination Scale Factor: **0.9999755578**

IaRCS Zone 14 Northing: **6326764.755sft** Easting: **24417770.490sft**  
Mapping Angle: **-0°11'34"** Combination Scale Factor: **0.9999978608**

**Monument Type:** 5/8" dia. driven aluminum rod with a 2-1/2" dia. aluminum cap and permanent magnet encased in a 5" dia. PVC pipe with an aluminum access cover.

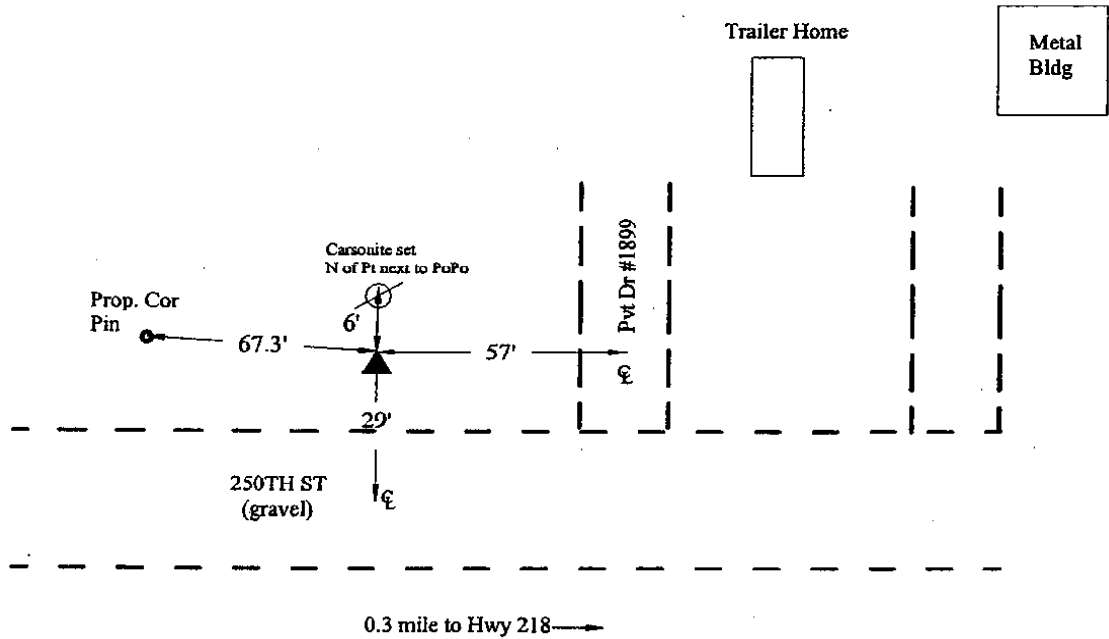

4

**2001-019**  
BRS/RKE/SBS  
March 7, 2001

Set NGS style rod monument with access cover

*This document was prepared by DCI on December 17, 2014 for use by Lee County, Iowa*