

Lee County, Iowa

Horizontal Datum: **NAD 83(2011)** - Vertical Datum: **NAVD 1988**
Iowa State Plane South Zone (1402)
Iowa Regional Coordinate System Zone 14 Burlington
US Survey Feet
2014

Point Name: **28**

Designation: Lee Co. GPS Control Pt. 2001-028 (Set by ASI in 2001)

NAD 83(NA2011) Latitude: **N40°33'13.28385"** Longitude: **W91°29'43.73768"**
NAVD 88 Ortho Height: **693.410sft** Ellip. Ht: **584.287sft** **Geoid12A**

Iowa South Zone (1402) Northing: **208145.757sft** Easting: **2197403.323sft**
Mapping Angle: **1°19'13"** Combination Scale Factor: **0.9999838293**

IaRCS Zone 14 Northing: **6310734.748sft** Easting: **24431782.275sft**
Mapping Angle: **-0°09'35"** Combination Scale Factor: **0.9999954369**

Monument Type: 5/8" dia. driven aluminum rod with a 2-1/2" dia. aluminum cap and permanent magnet encased in a 5" dia. PVC pipe with an aluminum access cover.

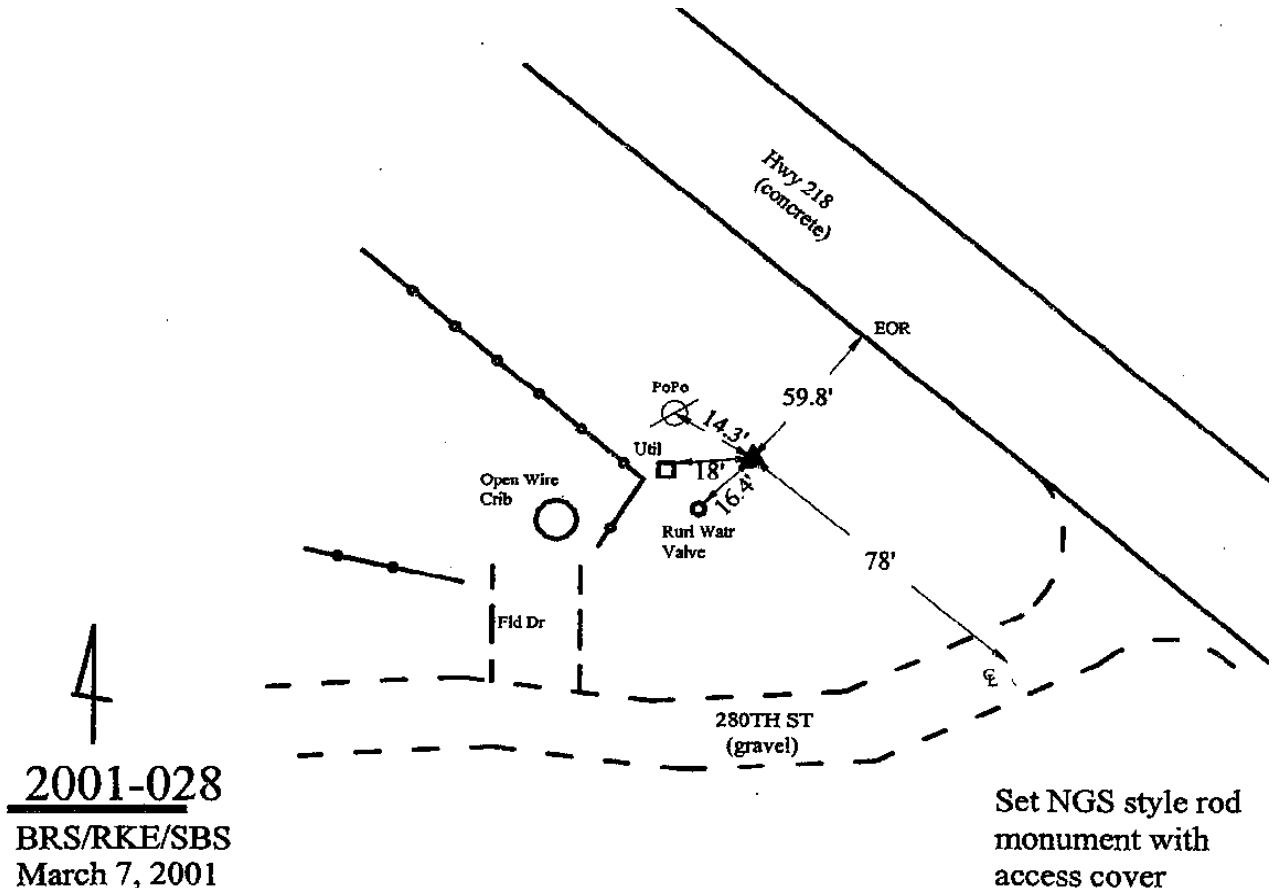

2001-028
BRS/RKE/SBS
March 7, 2001

This document was prepared by DCI on December 17, 2014 for use by Lee County, Iowa