

Lee County, Iowa

Horizontal Datum: **NAD 83(2011)** - Vertical Datum: **NAVD 1988**
Iowa State Plane South Zone (1402)
Iowa Regional Coordinate System Zone 14 Burlington
US Survey Feet
2014

Point Name: **30**

Designation: Lee Co. GPS Control Pt. 2001-030 (Set by ASI in 2001)

NAD 83(NA2011) Latitude: **N40°38'29.29336"** Longitude: **W91°29'20.43041"**
NAVD 88 Ortho Height: **638.380sft** Ellip. Ht: **529.292sft** **Geoid12A**

Iowa South Zone (1402) Northing: **240159.349sft** Easting: **2198462.667sft**
Mapping Angle: **1°19'29"** Combination Scale Factor: **0.9999704575**

IaRCS Zone 14 Northing: **6342710.923sft** Easting: **24433668.234sft**
Mapping Angle: **-0°09'20"** Combination Scale Factor: **0.9999977712**

Monument Type: 5/8" dia. driven aluminum rod with a 2-1/2" dia. aluminum cap and permanent magnet encased in a 5" dia. PVC pipe with an aluminum access cover.

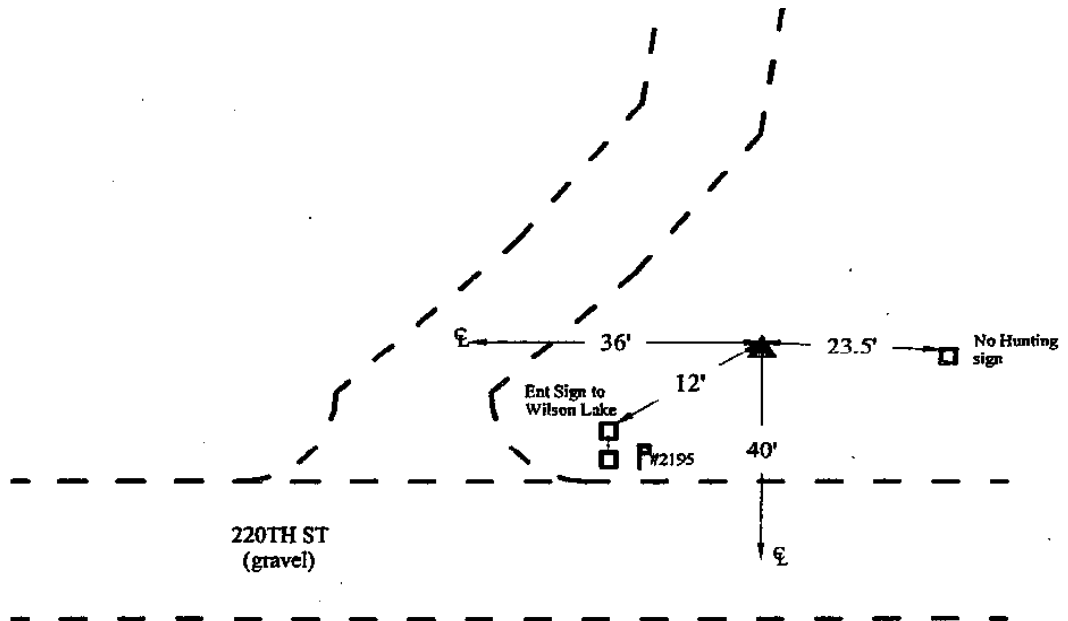

4

2001-030
BRS/RKE/SBS
March 7, 2001

Set NGS style rod
monument with
access cover

This document was prepared by DCI on December 17, 2014 for use by Lee County, Iowa