

**Lee County, Iowa**

Horizontal Datum: **NAD 83(2011)** - Vertical Datum: **NAVD 1988**  
Iowa State Plane South Zone (1402)  
Iowa Regional Coordinate System Zone 14 Burlington  
US Survey Feet  
**2014**

Point Name: **31**

**Designation:** Lee Co. GPS Control Pt. 2001-031 (Set by ASI in 2001)

NAD 83(NA2011) Latitude: **N40°40'44.96997"** Longitude: **W91°29'17.74746"**  
NAVD 88 Ortho Height: **568.570sft** Ellip. Ht: **459.528sft** **Geoid12A**

Iowa South Zone (1402) Northing: **253891.126sft** Easting: **2198351.906sft**  
Mapping Angle: **1°19'30"** Combination Scale Factor: **0.9999676300**

IaRCS Zone 14 Northing: **6356441.396sft** Easting: **24433912.271sft**  
Mapping Angle: **-0°09'19"** Combination Scale Factor: **1.0000010634**

**Monument Type:** 5/8" dia. driven aluminum rod with a 2-1/2" dia. aluminum cap and permanent magnet encased in a 5" dia. PVC pipe with an aluminum access cover.

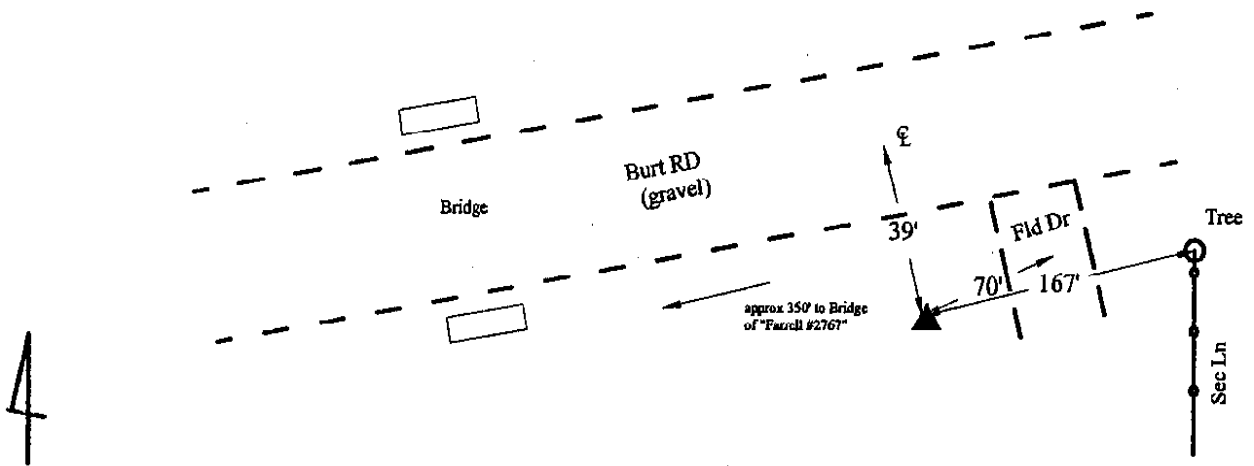

**4**  
**2001-031**  
**BRS/RKE/SBS**  
**March 7, 2001**

**Set NGS style rod  
monument with  
access cover**