

Lee County, Iowa
Horizontal Datum: **NAD 83(2011)** - Vertical Datum: **NAVD 1988**
Iowa State Plane South Zone (1402)
Iowa Regional Coordinate System Zone 14 Burlington
US Survey Feet
2014

Point Name: **39**

Designation: Lee Co. GPS Control Pt. 2001-039 (Set by ASI in 2001)

NAD 83(NA2011) Latitude: **N40°33'07.80351"** Longitude: **W91°25'40.52769"**
NAVD 88 Ortho Height: **542.862sft** Ellip. Ht: **433.675sft** **Geoid12A**

Iowa South Zone (1402) Northing: **208031.187sft** Easting: **2216185.185sft**
Mapping Angle: **1°21'54"** Combination Scale Factor: **0.9999913141**

IaRCS Zone 14 Northing: **6310135.025sft** Easting: **24450555.100sft**
Mapping Angle: **-0°06'56"** Combination Scale Factor: **1.0000000992**

Monument Type: 5/8" dia. driven aluminum rod with a 2-1/2" dia. aluminum cap and permanent magnet encased in a 5" dia. PVC pipe with an aluminum access cover.

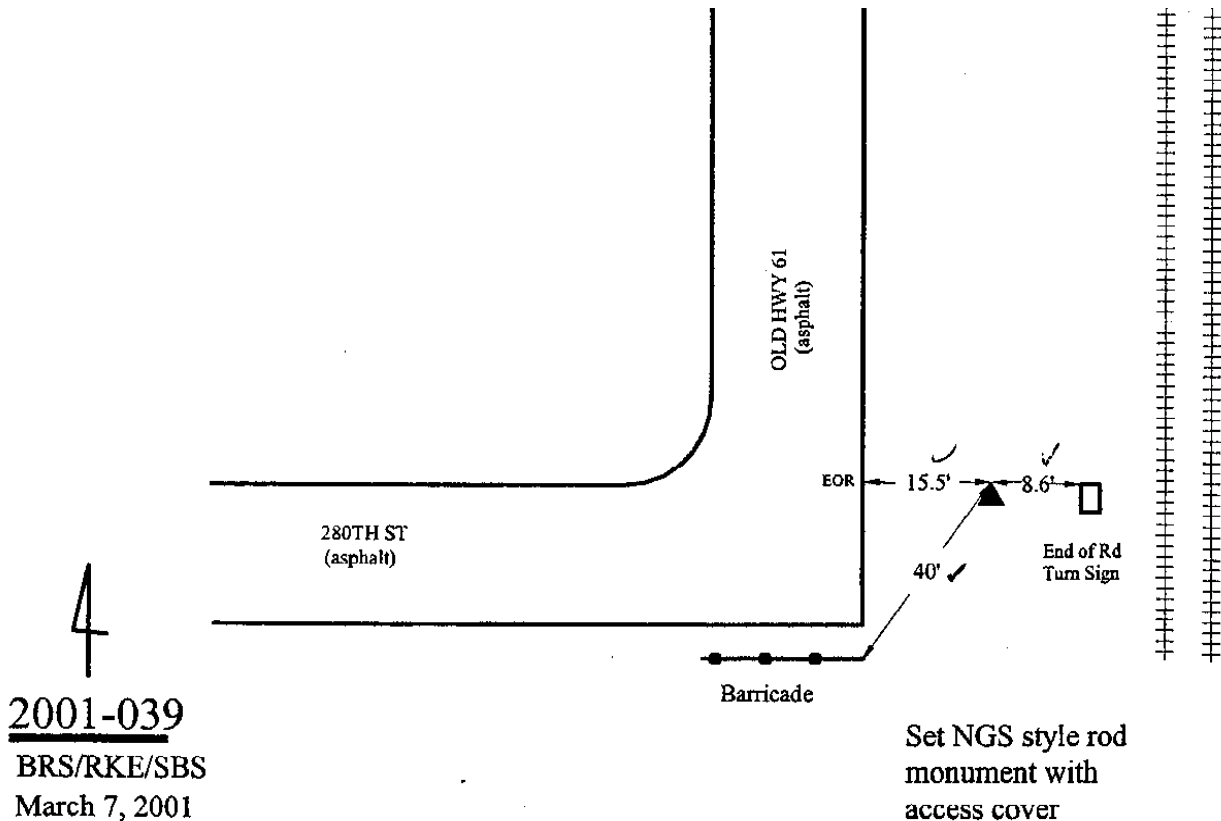

This document was prepared by DCI on December 17, 2014 for use by Lee County, Iowa