

**Lee County, Iowa**

Horizontal Datum: **NAD 83(2011)** - Vertical Datum: **NAVD 1988**  
Iowa State Plane South Zone (1402)  
Iowa Regional Coordinate System Zone 14 Burlington  
US Survey Feet  
**2014**

Point Name: **45**

**Designation:** Lee Co. GPS Control Pt. 2001-045 (Set by ASI in 2001)

NAD 83(NA2011) Latitude: **N40°48'46.59726"** Longitude: **W91°25'48.37315"**  
NAVD 88 Ortho Height: **689.370sft** Ellip. Ht: **580.460sft** **Geoid12A**

Iowa South Zone (1402) Northing: **302997.248sft** Easting: **2213319.102sft**  
Mapping Angle: **1°21'48"** Combination Scale Factor: **0.9999434599**

IaRCS Zone 14 Northing: **6405146.377sft** Easting: **24450144.161sft**  
Mapping Angle: **-0°07'04"** Combination Scale Factor: **0.9999931416**

**Monument Type:** 5/8" dia. driven aluminum rod with a 2-1/2" dia. aluminum cap and permanent magnet encased in a 5" dia. PVC pipe with an aluminum access cover.

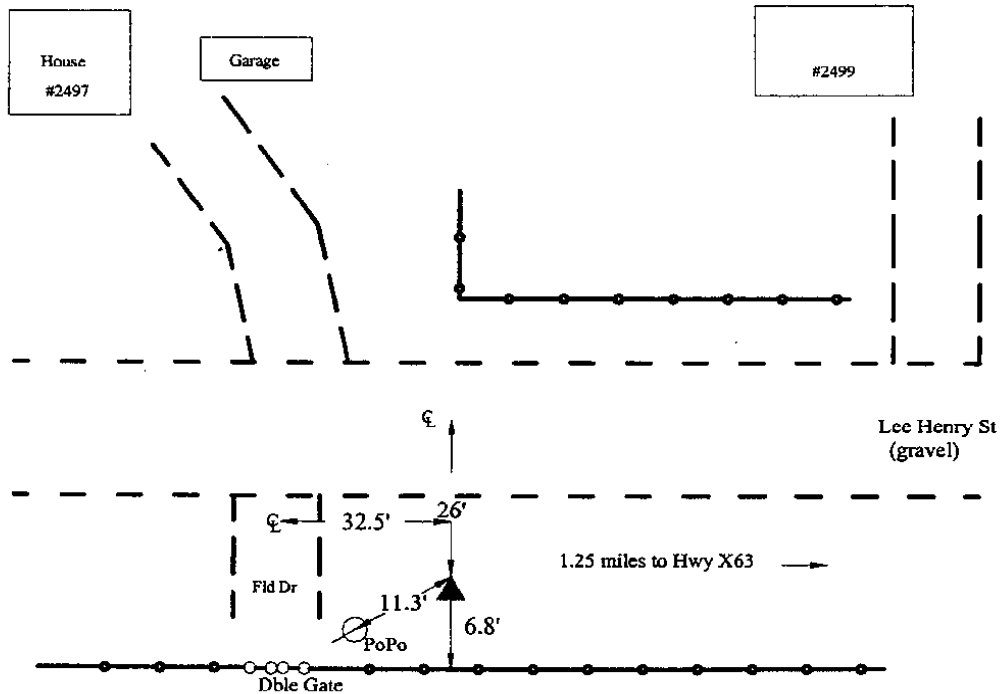

4

**2001-045**

**BRS/RKE/SBS**

**March 7, 2001**

**Set NGS style rod monument with access cover**

*This document was prepared by DCI on December 17, 2014 for use by Lee County, Iowa*