

Lee County, Iowa

Horizontal Datum: **NAD 83(2011)** - Vertical Datum: **NAVD 1988**
Iowa State Plane South Zone (1402)
Iowa Regional Coordinate System Zone 14 Burlington
US Survey Feet
2014

Point Name: **50**

Designation: Lee Co. GPS Control Pt. 2001-050 (Set by ASI in 2001)

NAD 83(NA2011) Latitude: **N40°35'39.61466"** Longitude: **W91°24'09.20019"**
NAVD 88 Ortho Height: **523.200sft** Ellip. Ht: **414.001sft** **Geoid12A**

Iowa South Zone (1402) Northing: **223559.182sft** Easting: **2222862.623sft**
Mapping Angle: **1°22'54"** Combination Scale Factor: **0.9999842599**

IaRCS Zone 14 Northing: **6325485.478sft** Easting: **24457631.645sft**
Mapping Angle: **-0°05'57"** Combination Scale Factor: **1.0000002955**

Monument Type: 5/8" dia. driven aluminum rod with a 2-1/2" dia. aluminum cap and permanent magnet encased in a 5" dia. PVC pipe with an aluminum access cover.

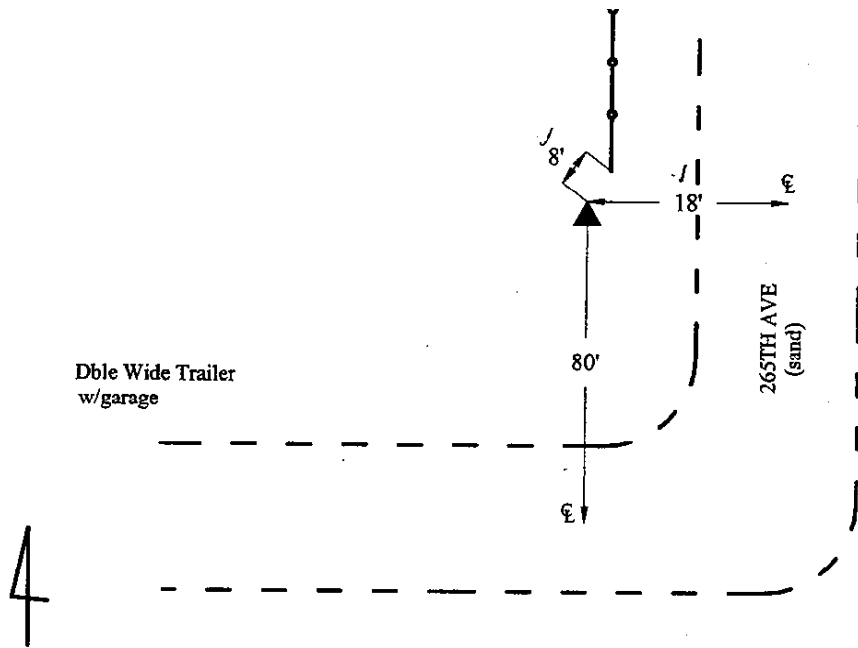

2001-050
BRS/RKE/SBS
March 8, 2001

Set NGS style rod monument with access cover

This document was prepared by DCI on December 17, 2014 for use by Lee County, Iowa