

Lee County, Iowa

Horizontal Datum: **NAD 83(2011)** - Vertical Datum: **NAVD 1988**
Iowa State Plane South Zone (1402)
Iowa Regional Coordinate System Zone 14 Burlington
US Survey Feet
2014

Point Name: **57**

Designation: Lee Co. GPS Control Pt. 2001-057 (Set by ASI in 2001)

NAD 83(NA2011) Latitude: **N40°43'30.46305"** Longitude: **W91°18'20.11395"**
NAVD 88 Ortho Height: **677.680sft** Ellip. Ht: **568.583sft** **Geoid12A**

Iowa South Zone (1402) Northing: **271858.873sft** Easting: **2248582.494sft**
Mapping Angle: **1°26'44"** Combination Scale Factor: **0.9999554956**

IaRCS Zone 14 Northing: **6373105.387sft** Easting: **24484592.223sft**
Mapping Angle: **-0°02'11"** Combination Scale Factor: **0.9999911387**

Monument Type: 5/8" dia. driven aluminum rod with a 2-1/2" dia. aluminum cap and permanent magnet encased in a 5" dia. PVC pipe with an aluminum access cover.

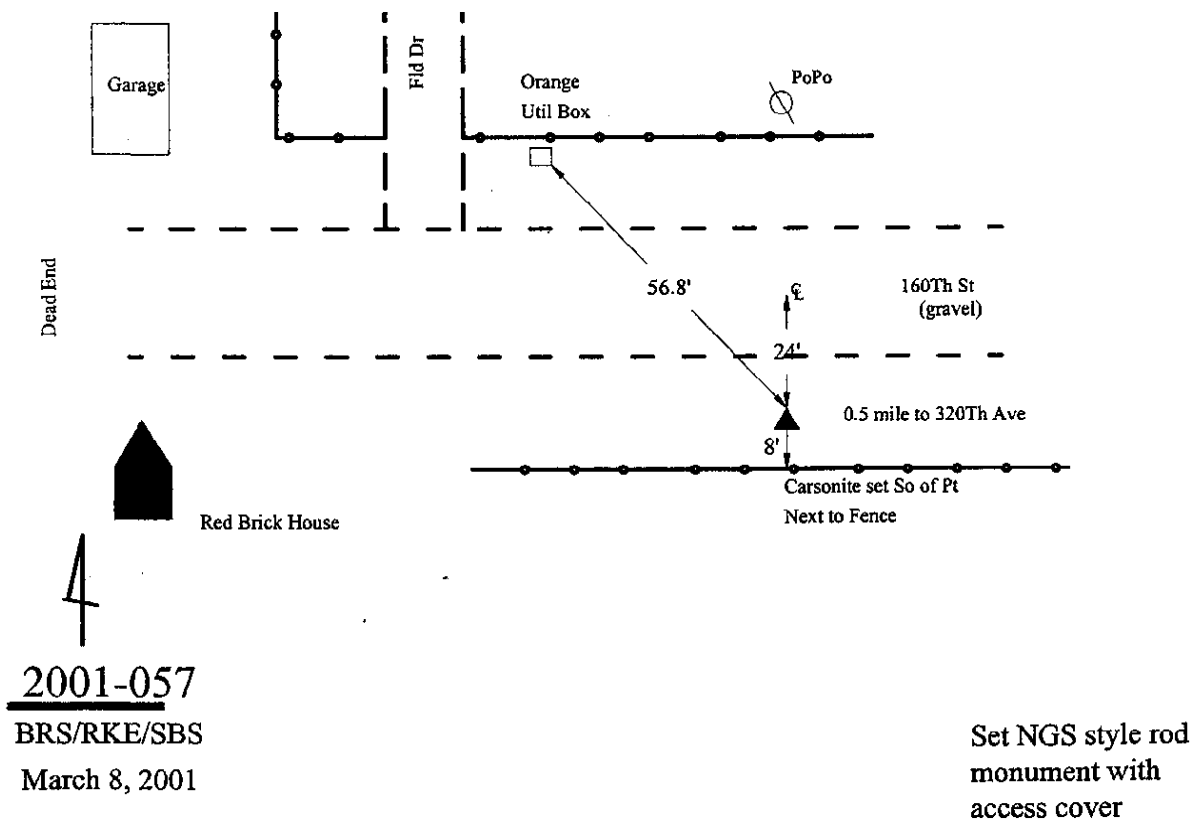

This document was prepared by DCI on December 17, 2014 for use by Lee County, Iowa