

Lee County, Iowa

Horizontal Datum: **NAD 83(2011)** - Vertical Datum: **NAVD 1988**
Iowa State Plane South Zone (1402)
Iowa Regional Coordinate System Zone 14 Burlington
US Survey Feet
2014

Point Name: **88**

Designation: Lee Co. GPS Control Pt. 2001-088 (Set by ASI in 2001)

NAD 83(NA2011) Latitude: **N40°23'19.53032"** Longitude: **W91°27'05.55117"**
NAVD 88 Ortho Height: **493.230sft** Ellip. Ht: **384.378sft** **Geoid12A**

Iowa South Zone (1402) Northing: **148357.941sft** Easting: **2211025.673sft**
Mapping Angle: **1°20'58"** Combination Scale Factor: **1.0000296850**

IaRCS Zone 14 Northing: **6250615.460sft** Easting: **24443855.870sft**
Mapping Angle: **-0°07'50"** Combination Scale Factor: **1.0000032602**

Monument Type: 5/8" dia. driven aluminum rod with a 2-1/2" dia. aluminum cap and permanent magnet encased in a 5" dia. PVC pipe with an aluminum access cover.

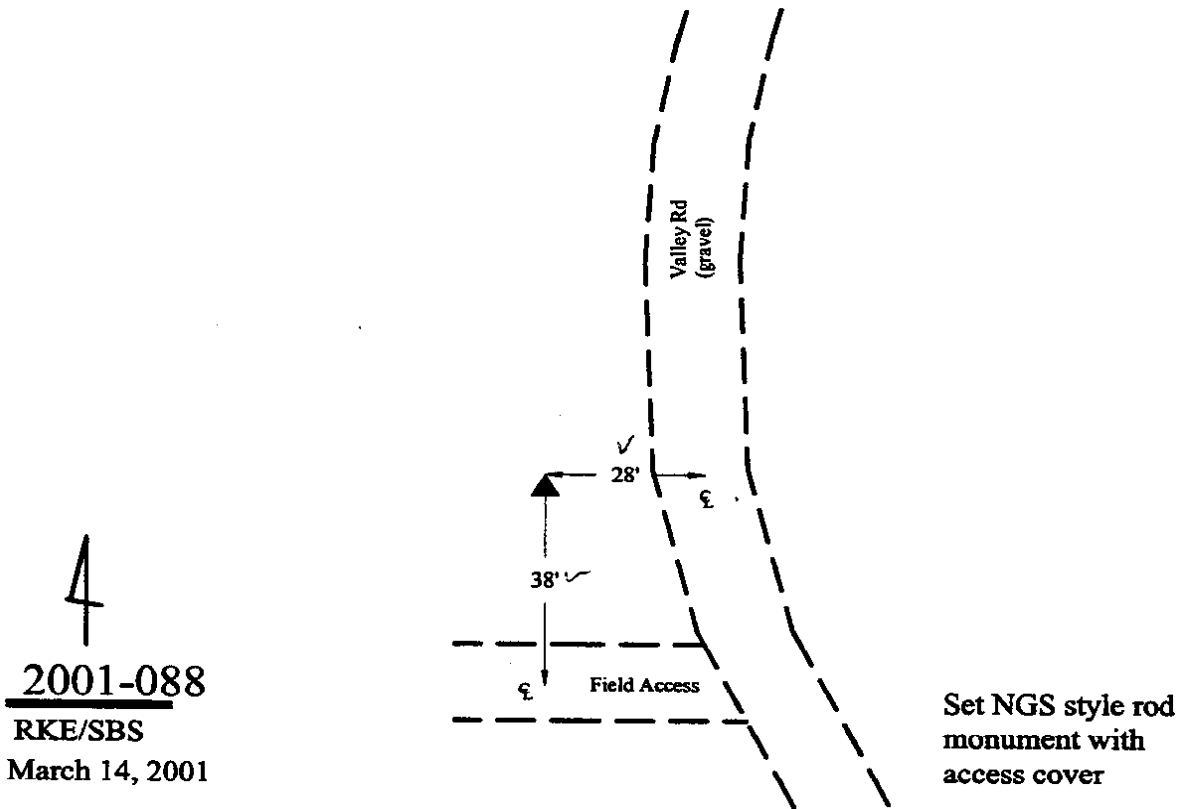

This document was prepared by DCI on December 17, 2014 for use by Lee County, Iowa