

Lee County, Iowa

Horizontal Datum: **NAD 83(2011)** - Vertical Datum: **NAVD 1988**

Iowa State Plane South Zone (1402)

Iowa Regional Coordinate System Zone 14 Burlington

US Survey Feet

2014

Point Name: **112**

Designation: Lee Co. GPS Control Pt. 2001-112 (Set by ASI in 2001)

NAD 83(NA2011) Latitude: **N40°28'41.60963"** Longitude: **W91°22'32.37109"**

NAVD 88 Ortho Height: **523.160sft** Ellip. Ht: **414.033sft** **Geoid12A**

Iowa South Zone (1402) Northing: **181450.299sft** Easting: **2231363.289sft**

Mapping Angle: **1°23'58"** Combination Scale Factor: **1.0000075568**

laRCS Zone 14 Northing: **6283170.791sft** Easting: **24465041.284sft**

Mapping Angle: **-0°04'54"** Combination Scale Factor: **0.9999996389**

Monument Type: 5/8" dia. driven aluminum rod with a 2-1/2" dia. aluminum cap and permanent magnet encased in a 5" dia. PVC pipe with an aluminum access cover.

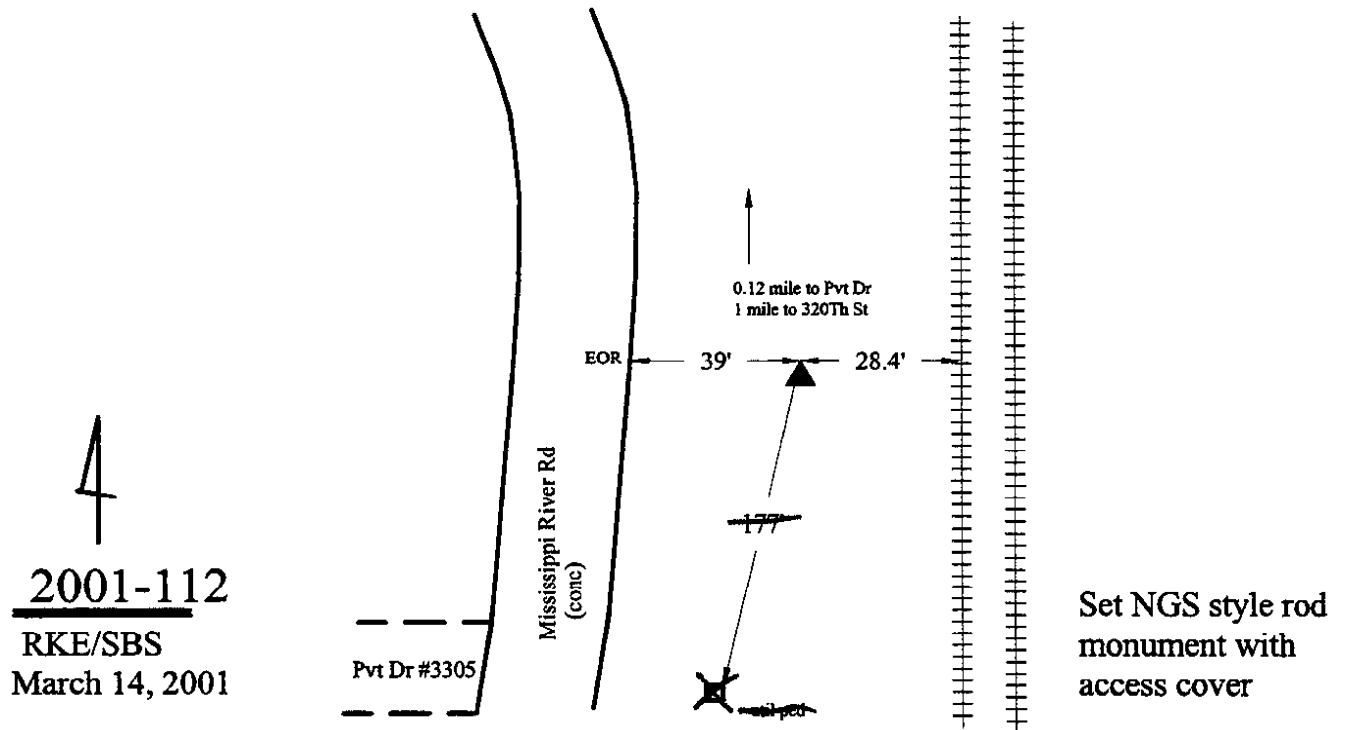

This document was prepared by DCI on December 17, 2014 for use by Lee County, Iowa