

Lee County, Iowa

Horizontal Datum: **NAD 83(2011)** - Vertical Datum: **NAVD 1988**
Iowa State Plane South Zone (1402)
Iowa Regional Coordinate System Zone 14 Burlington
US Survey Feet
2014

Point Name: **121**

Designation: Lee Co. GPS Control Pt. 2001-121 (Set by ASI in 2001)

NAD 83(NA2011) Latitude: **N40°37'24.51417"** Longitude: **W91°24'26.23844"**
NAVD 88 Ortho Height: **553.900sft** Ellip. Ht: **444.732sft** **Geoid12A**

Iowa South Zone (1402) Northing: **234140.433sft** Easting: **2221293.214sft**
Mapping Angle: **1°22'42"** Combination Scale Factor: **0.9999775828**

IaRCS Zone 14 Northing: **6336103.952sft** Easting: **24456336.189sft**
Mapping Angle: **-0°06'09"** Combination Scale Factor: **0.9999989564**

Monument Type: 5/8" dia. driven aluminum rod with a 2-1/2" dia. aluminum cap and permanent magnet encased in a 5" dia. PVC pipe with an aluminum access cover.

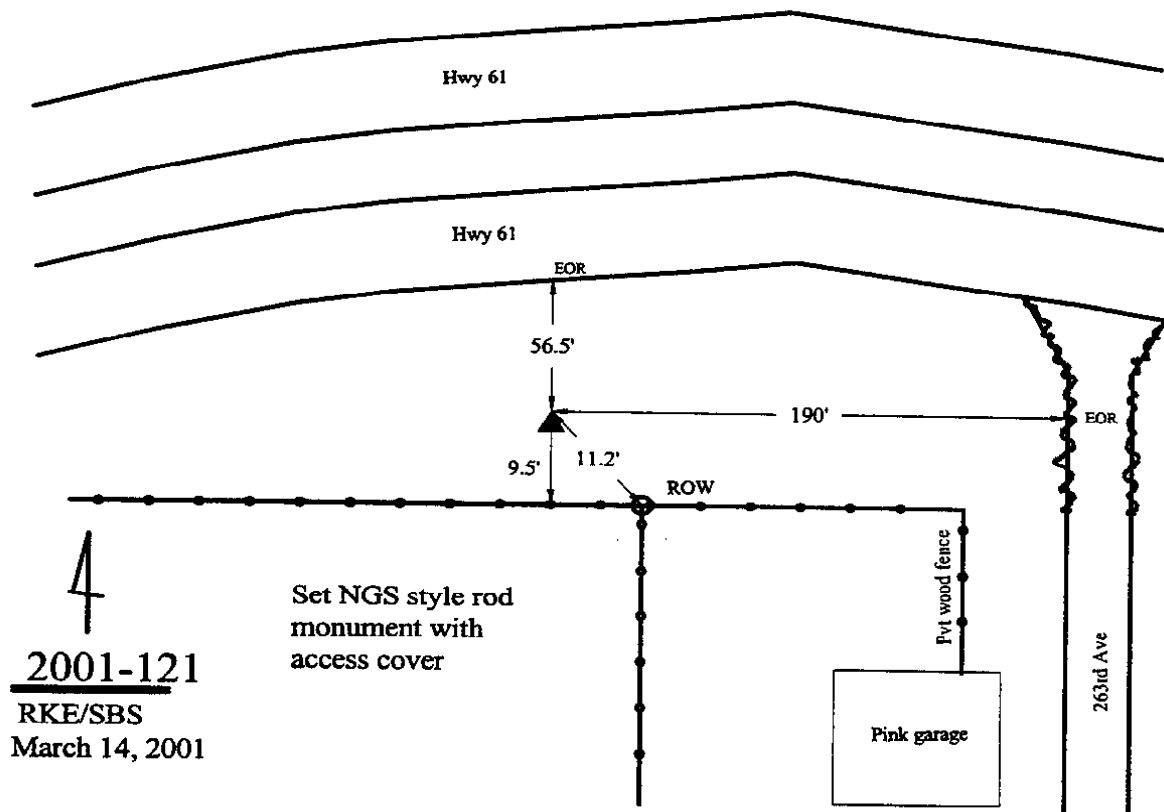

This document was prepared by DCI on December 17, 2014 for use by Lee County, Iowa