

Lee County, Iowa

Horizontal Datum: **NAD 83(2011)** - Vertical Datum: **NAVD 1988**
Iowa State Plane South Zone (1402)
Iowa Regional Coordinate System Zone 14 Burlington
US Survey Feet
2014

Point Name: **123**

Designation: Lee Co. GPS Control Pt. 2001-123 (Set by ASI in 2001)

NAD 83(NA2011) Latitude: **N40°39'09.61181"** Longitude: **W91°23'31.41112"**
NAVD 88 Ortho Height: **694.170sft** Ellip. Ht: **585.040sft** **Geoid12A**

Iowa South Zone (1402) Northing: **244875.414sft** Easting: **2225262.019sft**
Mapping Angle: **1°23'19"** Combination Scale Factor: **0.9999659232**

IaRCS Zone 14 Northing: **6346733.026sft** Easting: **24460581.213sft**
Mapping Angle: **-0°05'33"** Combination Scale Factor: **0.9999918579**

Monument Type: 5/8" dia. driven aluminum rod with a 2-1/2" dia. aluminum cap and permanent magnet encased in a 5" dia. PVC pipe with an aluminum access cover.

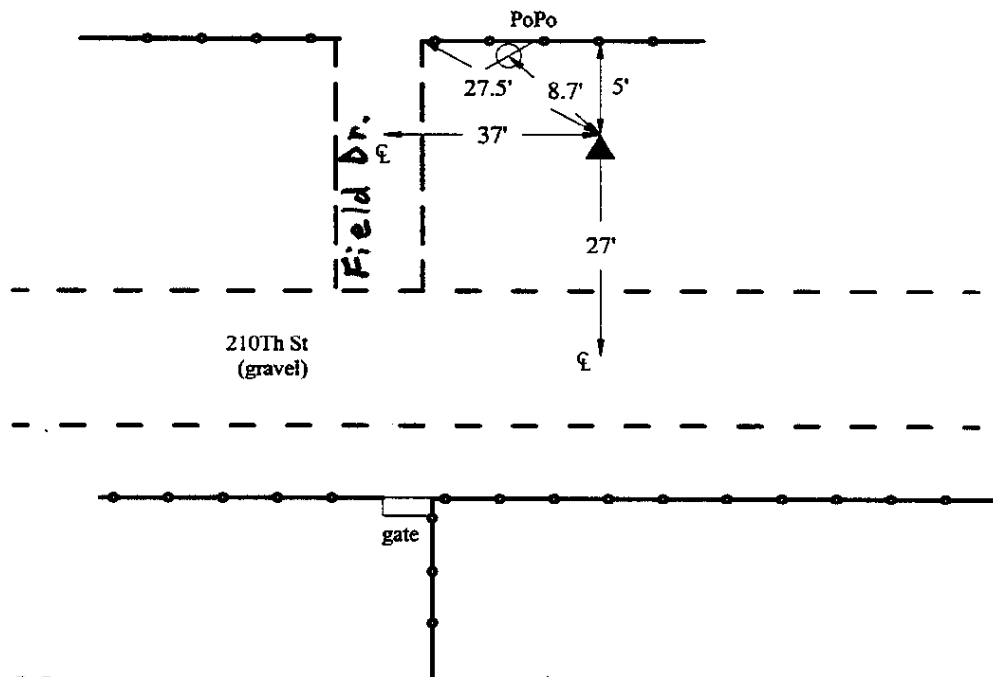

2001-123
RKE/SBS
March 14, 2001

Set NGS style rod
monument with
access cover

This document was prepared by DCI on December 17, 2014 for use by Lee County, Iowa