

**Lee County, Iowa**

Horizontal Datum: **NAD 83(2011)** - Vertical Datum: **NAVD 1988**  
Iowa State Plane South Zone (1402)  
Iowa Regional Coordinate System Zone 14 Burlington  
US Survey Feet  
**2014**

Point Name: **124 (Destroyed)**

**Designation:** Lee Co. GPS Control Pt. 2001-124 (Set by ASI in 2001)

NAD 83(NA2011) Latitude: ~~**N40°37'01.515009"**~~ Longitude: ~~**W91°22'59.048710"**~~  
NAVD 88 Ortho Height: ~~**536.44sft**~~ Ellip. Ht: ~~**427.37sft**~~ ~~**Geoid96C**~~

Iowa South Zone (1402) Northing: ~~**231976.25sft**~~ Easting: ~~**2228071.14sft**~~  
Mapping Angle: ~~**1°23'40"**~~ Combination Scale Factor: ~~**0.99997948**~~

IaRCS Zone 14 Northing: ~~**N/Asft**~~ Easting: ~~**N/Asft**~~  
Mapping Angle: ~~**N/A**~~ Combination Scale Factor: ~~**N/A**~~

**Monument Type:** ~~5/8" dia. driven aluminum rod with a 2-1/2" dia. aluminum cap and permanent magnet encased in a 5" dia. PVC pipe with an aluminum access cover.~~

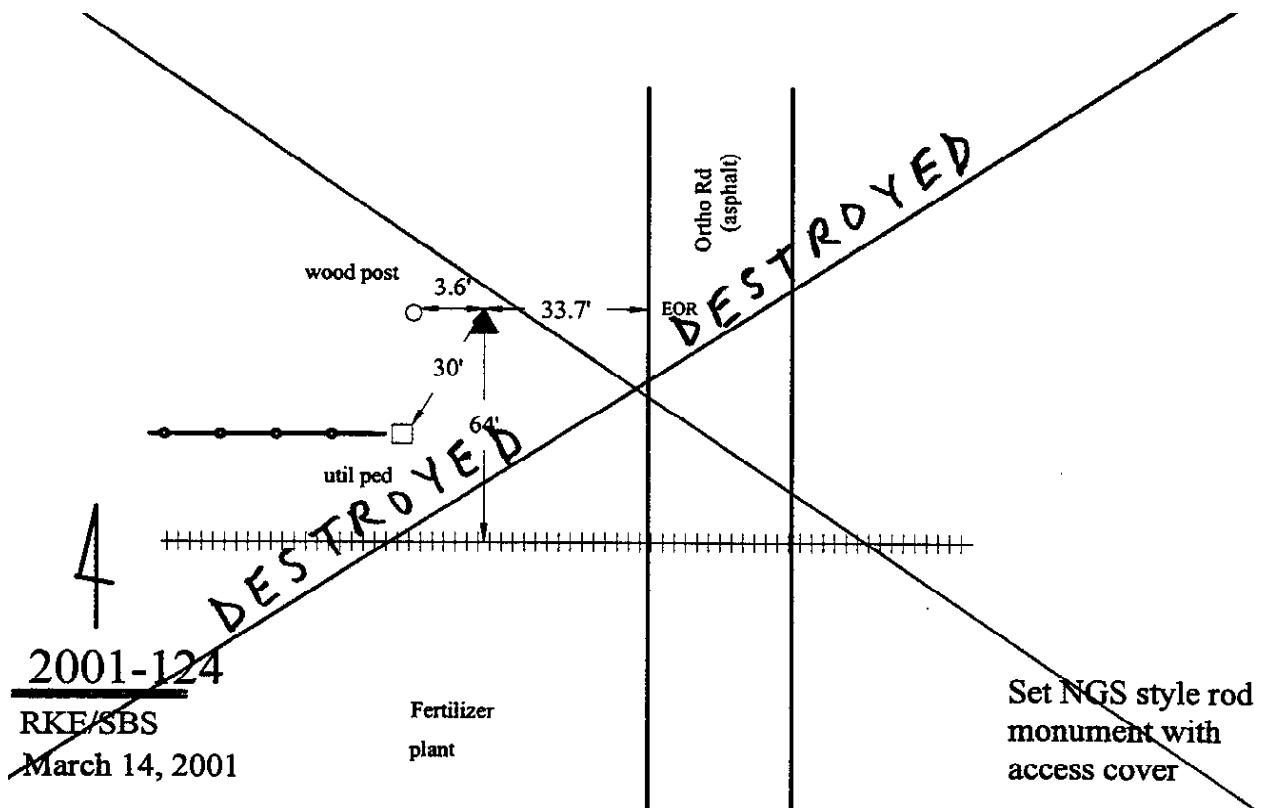

*This document was prepared by DCI on December 17, 2014 for use by Lee County, Iowa*