

Lee County, Iowa

Horizontal Datum: **NAD 83(2011)** - Vertical Datum: **NAVD 1988**

Iowa State Plane South Zone (1402)

Iowa Regional Coordinate System Zone 14 Burlington

US Survey Feet

2014

Point Name: **130**

Designation: Lee Co. GPS Control Pt. 2001-130 (Set by ASI in 2001)

NAD 83(NA2011) Latitude: **N40°39'10.39026"** Longitude: **W91°21'09.00975"**

NAVD 88 Ortho Height: **709.680sft** Ellip. Ht: **600.539sft** **Geoid12A**

Iowa South Zone (1402) Northing: **245222.626sft** Easting: **2236232.604sft**

Mapping Angle: **1°24'52"** Combination Scale Factor: **0.9999651478**

IaRCS Zone 14 Northing: **6346796.547sft** Easting: **24471557.387sft**

Mapping Angle: **-0°04'00"** Combination Scale Factor: **0.9999902670**

Monument Type: 5/8" dia. driven aluminum rod with a 2-1/2" dia. aluminum cap and permanent magnet encased in a 5" dia. PVC pipe with an aluminum access cover.

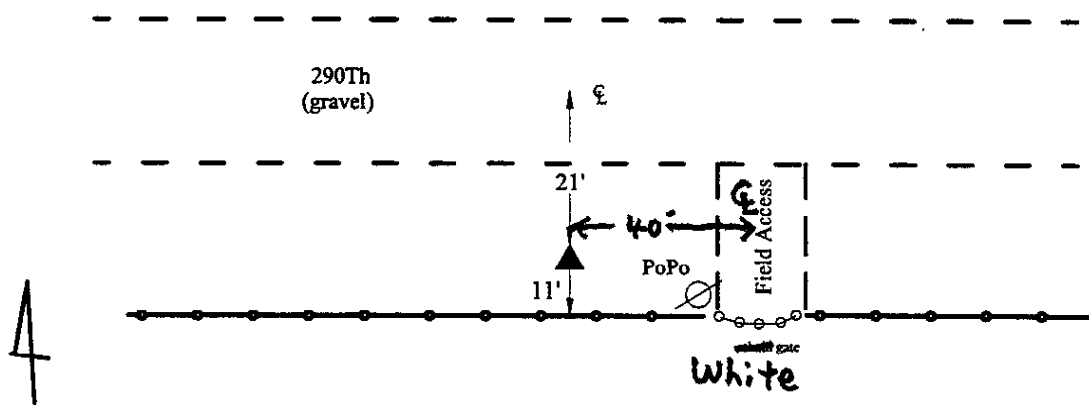

2001-130

RKE/SBS

March 14, 2001

Set NGS style rod
monument with
access cover

This document was prepared by DCI on December 17, 2014 for use by Lee County, Iowa