

**Lee County, Iowa**  
Horizontal Datum: **NAD 83(2011)** - Vertical Datum: **NAVD 1988**  
Iowa State Plane South Zone (1402)  
Iowa Regional Coordinate System Zone 14 Burlington  
US Survey Feet  
**2014**

Point Name: **200**

**Designation:** Des Moines Co. GPS Control Pt. 99-200 (Set by ASI in 1999)

NAD 83(NA2011) Latitude: **N40°48'56.53008"** Longitude: **W91°22'20.31161"**  
NAVD 88 Ortho Height: **707.550sft** Ellip. Ht: **598.614sft** **Geoid12A**

Iowa South Zone (1402) Northing: **304388.140sft** Easting: **2229287.736sft**  
Mapping Angle: **1°24'05"** Combination Scale Factor: **0.9999422710**

IaRCS Zone 14 Northing: **6406124.049sft** Easting: **24466144.199sft**  
Mapping Angle: **-0°04'48"** Combination Scale Factor: **0.9999907445**

**Monument Type:** 5/8" dia. driven aluminum rod with a 2-1/2" dia. aluminum cap and permanent magnet encased in a 5" dia. PVC pipe with an aluminum access cover.

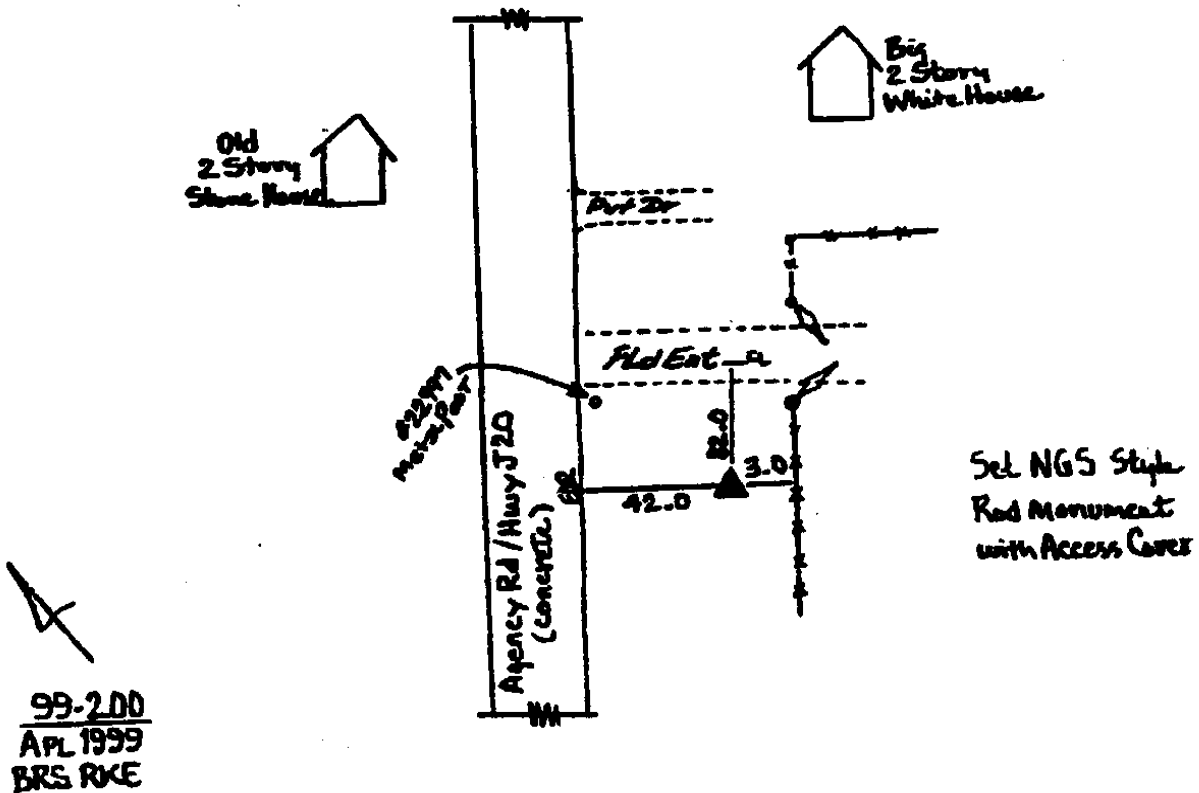

*This document was prepared by DCI on December 17, 2014 for use by Lee County, Iowa*