

**Lee County, Iowa**

Horizontal Datum: **NAD 83(2011)** - Vertical Datum: **NAVD 1988**  
Iowa State Plane South Zone (1402)  
Iowa Regional Coordinate System Zone 14 Burlington  
US Survey Feet  
**2014**

Point Name: **210**

**Designation:** Des Moines Co. GPS Control Pt. 99-210 (Set by ASI in 1999)

NAD 83(NA2011) Latitude: **N40°46'58.89785"** Longitude: **W91°19'08.57196"**  
NAVD 88 Ortho Height: **560.170sft** Ellip. Ht: **451.159sft** **Geoid12A**

Iowa South Zone (1402) Northing: **292852.367sft** Easting: **2244323.941sft**  
Mapping Angle: **1°26'12"** Combination Scale Factor: **0.9999532758**

IaRCS Zone 14 Northing: **6394202.816sft** Easting: **24480877.793sft**  
Mapping Angle: **-0°02'42"** Combination Scale Factor: **0.9999968887**

**Monument Type:** 5/8" dia. driven aluminum rod with a 2-1/2" dia. aluminum cap and permanent magnet encased in a 5" dia. PVC pipe with an aluminum access cover.

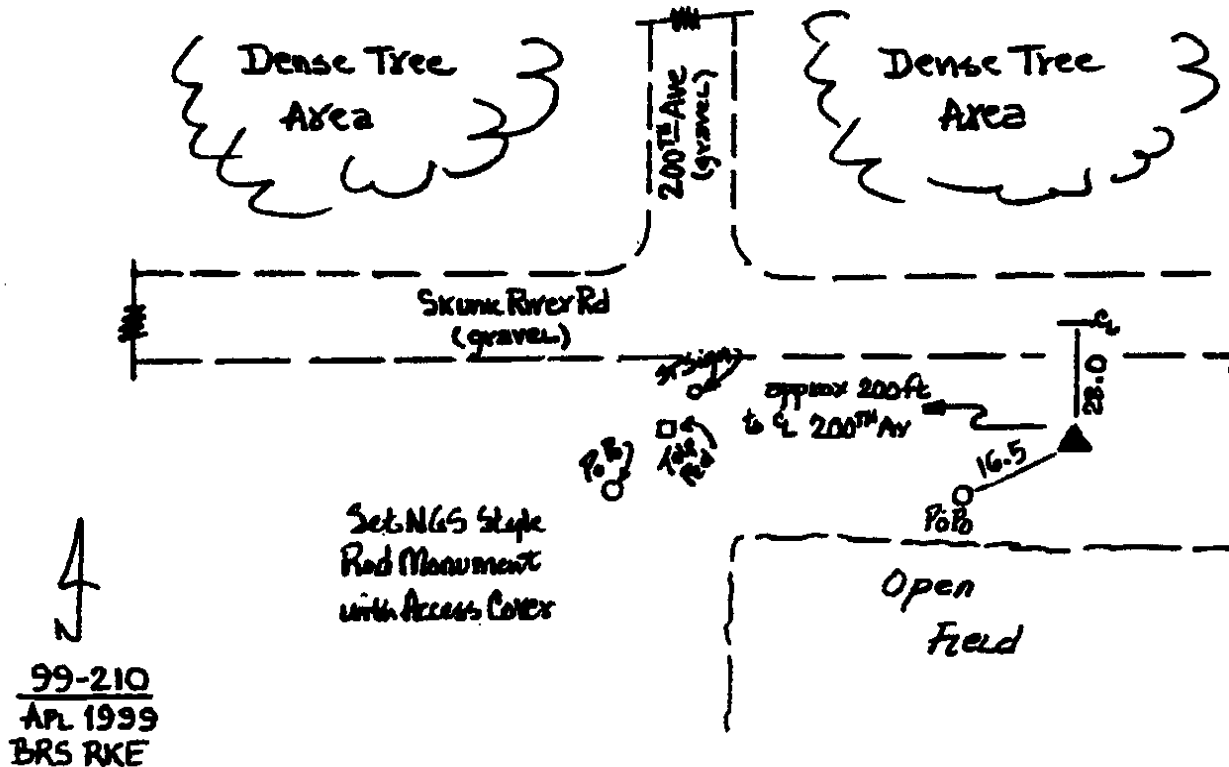

*This document was prepared by DCI on December 17, 2014 for use by Lee County, Iowa*