

Lee County, Iowa

Horizontal Datum: **NAD 83(2011)** - Vertical Datum: **NAVD 1988**
Iowa State Plane South Zone (1402)
Iowa Regional Coordinate System Zone 14 Burlington
US Survey Feet
2014

Point Name: **245**

Designation: Des Moines Co. GPS Control Pt. 99-245 (Set by ASI in 1999)

NAD 83(NA2011) Latitude: **N40°43'57.58324"** Longitude: **W91°08'34.69297"**
NAVD 88 Ortho Height: **532.490sft** Ellip. Ht: **423.331sft** **Geoid12A**

Iowa South Zone (1402) Northing: **275781.572sft** Easting: **2293565.603sft**
Mapping Angle: **1°33'09"** Combination Scale Factor: **0.9999613515**

IaRCS Zone 14 Northing: **6375863.295sft** Easting: **24529663.378sft**
Mapping Angle: **0°04'11"** Combination Scale Factor: **0.9999988043**

Monument Type: 5/8" dia. driven aluminum rod with a 2-1/2" dia. aluminum cap and permanent magnet encased in a 5" dia. PVC pipe with an aluminum access cover.

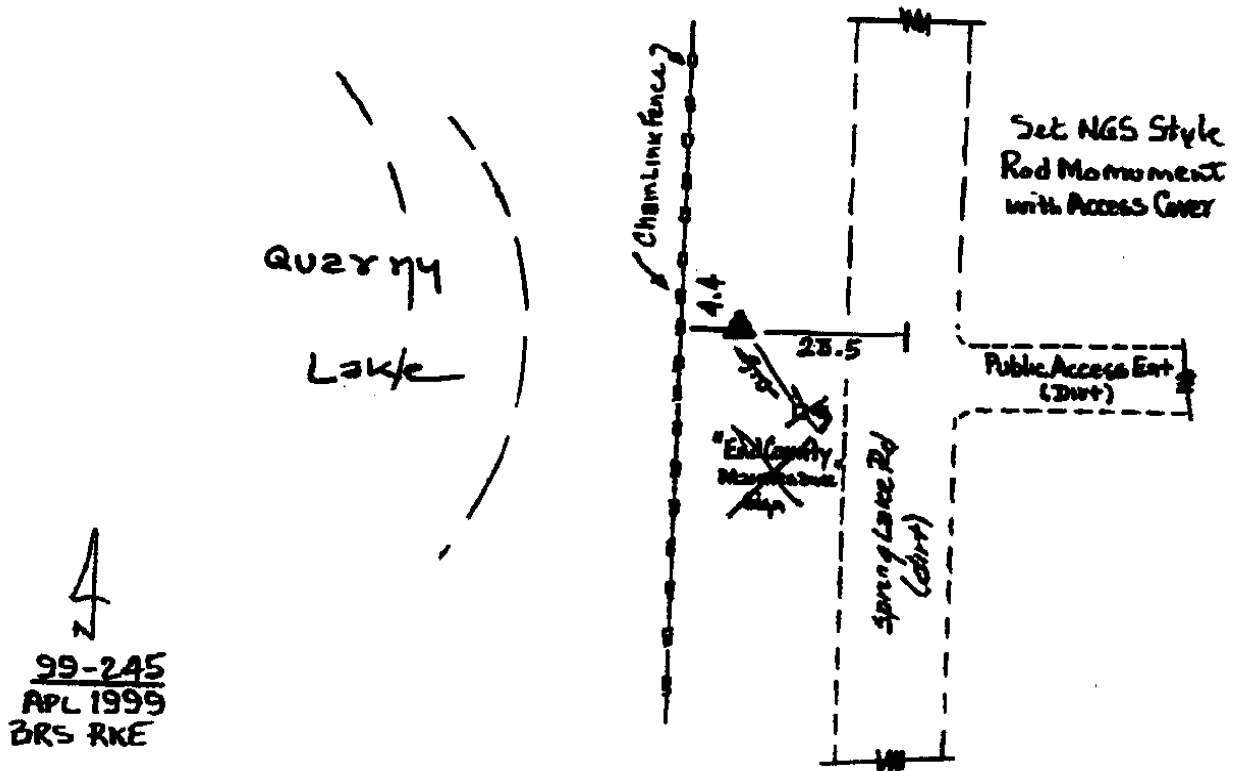

This document was prepared by DCI on December 17, 2014 for use by Lee County, Iowa