

Lee County, Iowa

Horizontal Datum: **NAD 83(2011)** - Vertical Datum: **NAVD 1988**
Iowa State Plane South Zone (1402)
Iowa Regional Coordinate System Zone 14 Burlington
US Survey Feet
2014

Point Name: **306 (Destroyed)**

Designation: ~~GBN control station "R 122=56 34" PID: LD0612~~

NAD 83(NA2011) Latitude: ~~**N40°43'17.438500"**~~ Longitude: ~~**W91°33'49.847620"**~~
NAVD 88 Ortho Height: ~~**700.35sft**~~ Ellip. Ht: ~~**591.46sft**~~ ~~**Geoid96C**~~

Iowa South Zone (1402) Northing: ~~**268841.64sft**~~ Easting: ~~**2177049.71sft**~~
Mapping Angle: ~~**1°16'31"**~~ Combination Scale Factor: ~~**0.99995486**~~

laRCS Zone 14 Northing: ~~**N/Asft**~~ Easting: ~~**N/Asft**~~
Mapping Angle: ~~**N/A**~~ Combination Scale Factor: ~~**N/A**~~

Monument Type: ~~A standard bench disk set in the top of a concrete post.~~

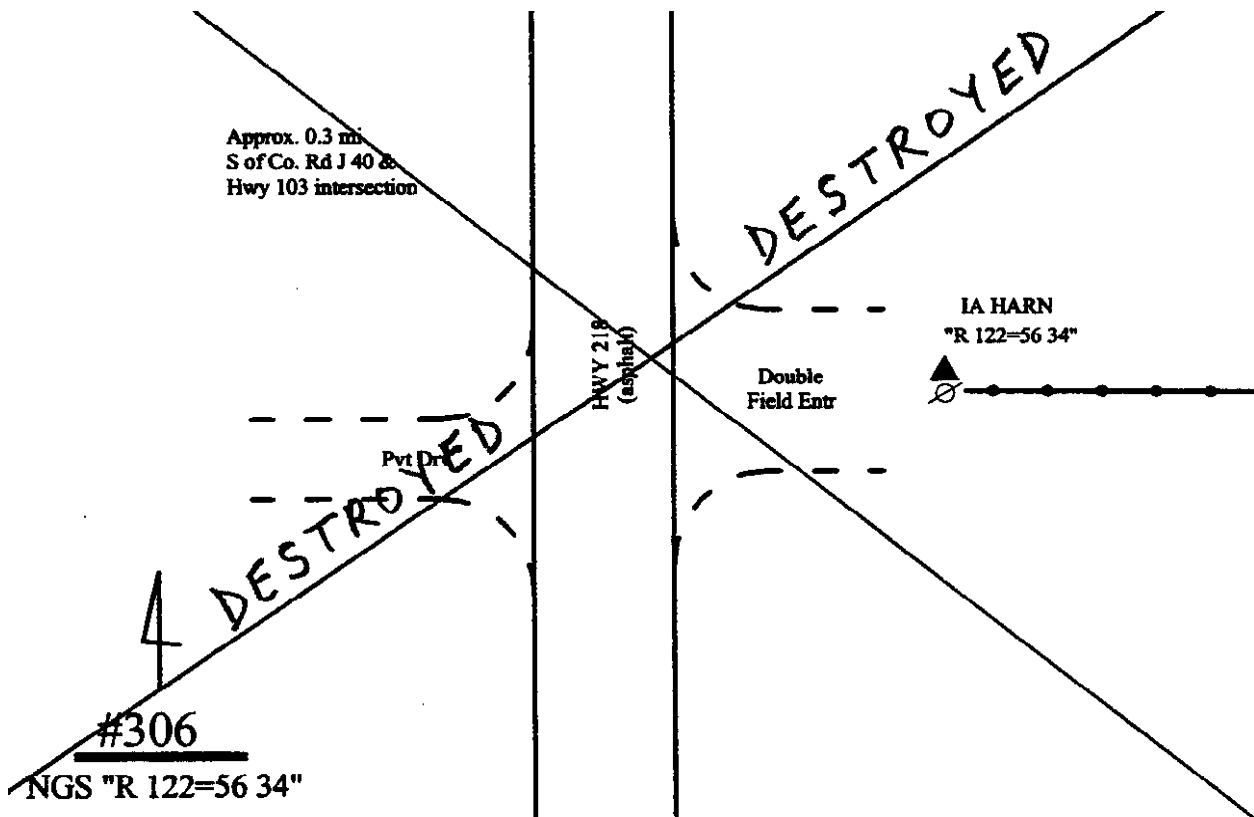

This document was prepared by DCI on December 17, 2014 for use by Lee County, Iowa