

Linn County and the City of Cedar Rapids, Iowa
 Iowa North Zone (1401)
 Horiz. Datum: NAD83(1996)
 Vert. Datum: NAVD 1988
 US Survey Feet
2005

Point Name: **CR 10B**

Designation: Station 10B, Set by Aero-Metric for the City of Cedar Rapids in 1995

Northing: **3456818.84**sft Easting: **5417021.90**sft

Orthometric Height: **728.75**sft Ellipsoid Height: **623.26**sft **Geold03**

Latitude: **41°58'05.67582"N** Longitude: **91°40'36.83700"W**

Mapping Angle: **1°14'08"** Combination Scale Factor: **0.99998958**

Monument Type: Berntsen monument with aluminum cap set in an open 6" dia. PVC pipe

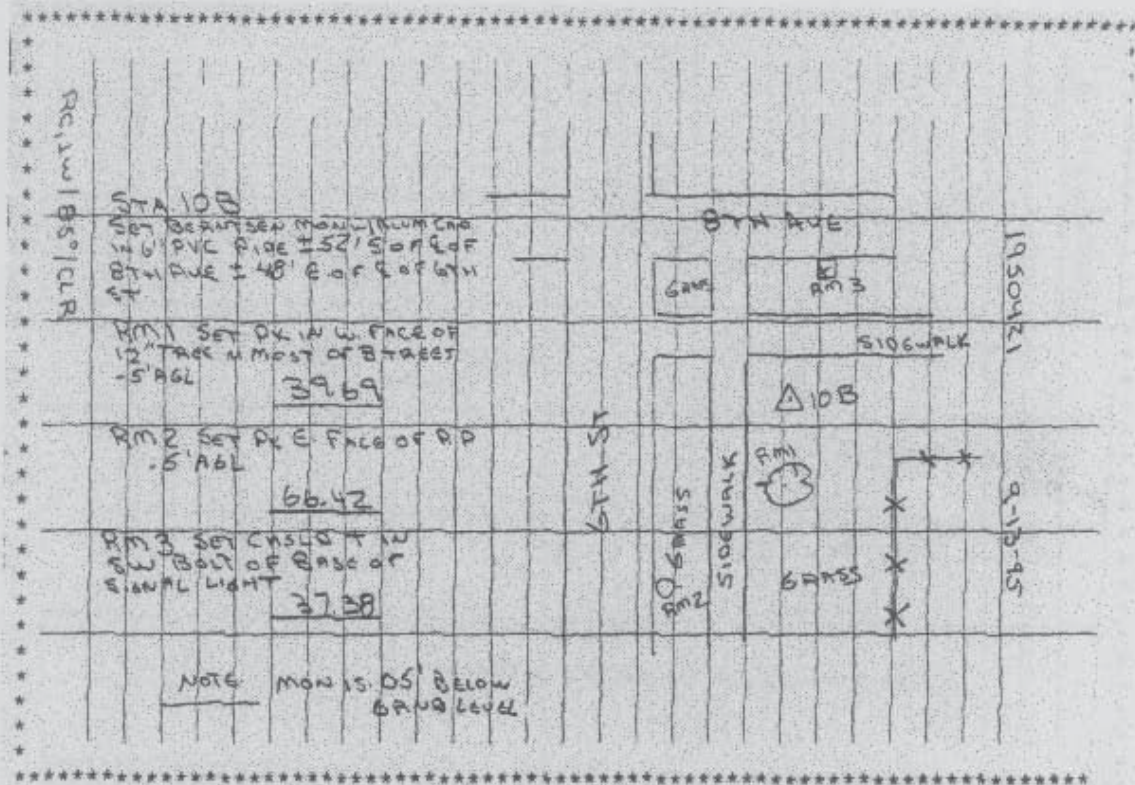

Prepared by DCI and GBC for Linn Co. and the City of Cedar Rapids, Iowa (Revised 08-05-05).