

**Linn County and the City of Cedar Rapids, Iowa**  
 Iowa North Zone (1401)  
 Horiz. Datum: NAD83(1996)  
 Vert. Datum: NAVD 1988  
 US Survey Feet  
 2005

Point Name: **CR 13A**

**Designation:** Station 13A, Set by Aero-Metric for the City of Cedar Rapids in 1995

Northing: **3442038.21**sft Easting: **5417635.72**sft

Orthometric Height: **735.85**sft Ellipsoid Height: **630.10**sft **Geoid03**

Latitude: **41°55'39.56477"N** Longitude: **91°40'32.93508"W**

Mapping Angle: **1°14'11"** Combination Scale Factor: **0.99999807**

**Monument Type:** Berntsen monument with aluminum cap set in an open 6" dia. PVC pipe

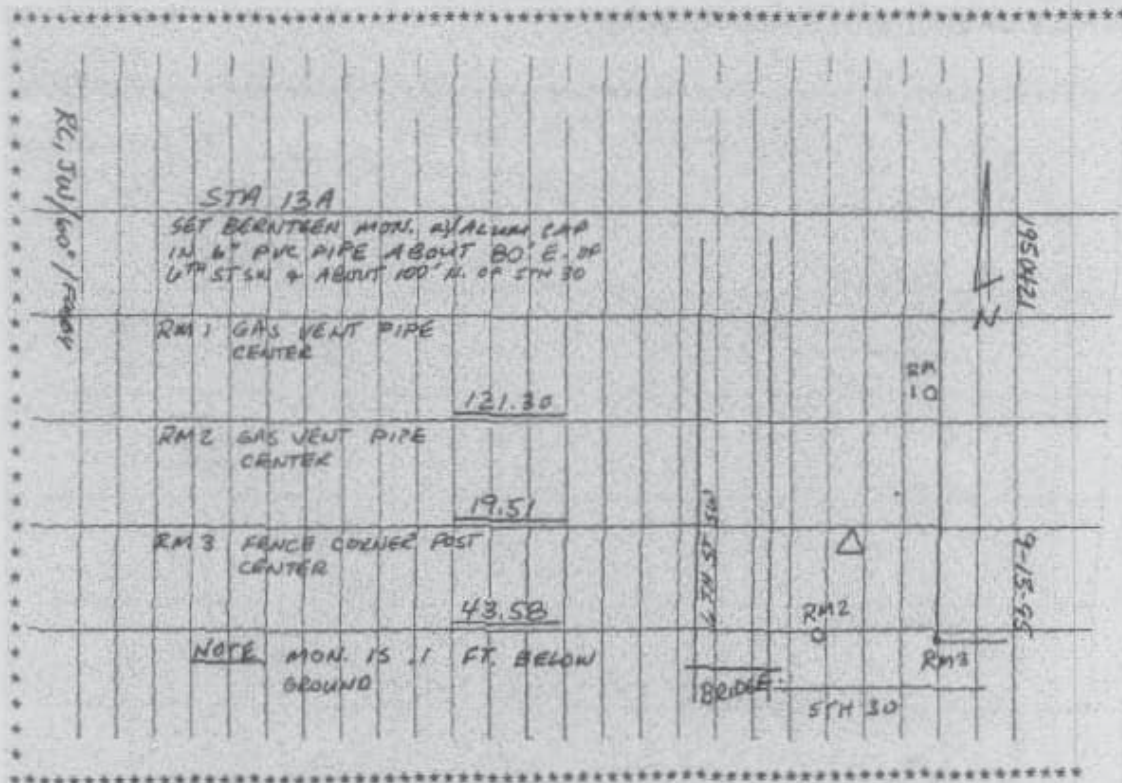

Prepared by DCI and GBC for Linn Co. and the City of Cedar Rapids, Iowa (Revised 08-05-05).