

Linn County and the City of Cedar Rapids, Iowa
 Iowa North Zone (1401)
 Horiz. Datum: NAD83(1996)
 Vert. Datum: NAVD 1988
 US Survey Feet
2005

Point Name: **CR 9B**

Designation: Station 9B, Set by Aero-Metric for the City of Cedar Rapids in 1995

Northing: **3456371.09sft** Easting: **5406319.92sft**

Orthometric Height: **840.75sft** Ellipsoid Height: **735.47sft** **Geoid03**

Latitude: **41°58'03.50873"N** Longitude: **91°42'58.59527"W**

Mapping Angle: **1°12'32"** Combination Scale Factor: **0.99998436**

Monument Type: Berntsen monument with aluminum cap set in an open 6" dia. PVC pipe

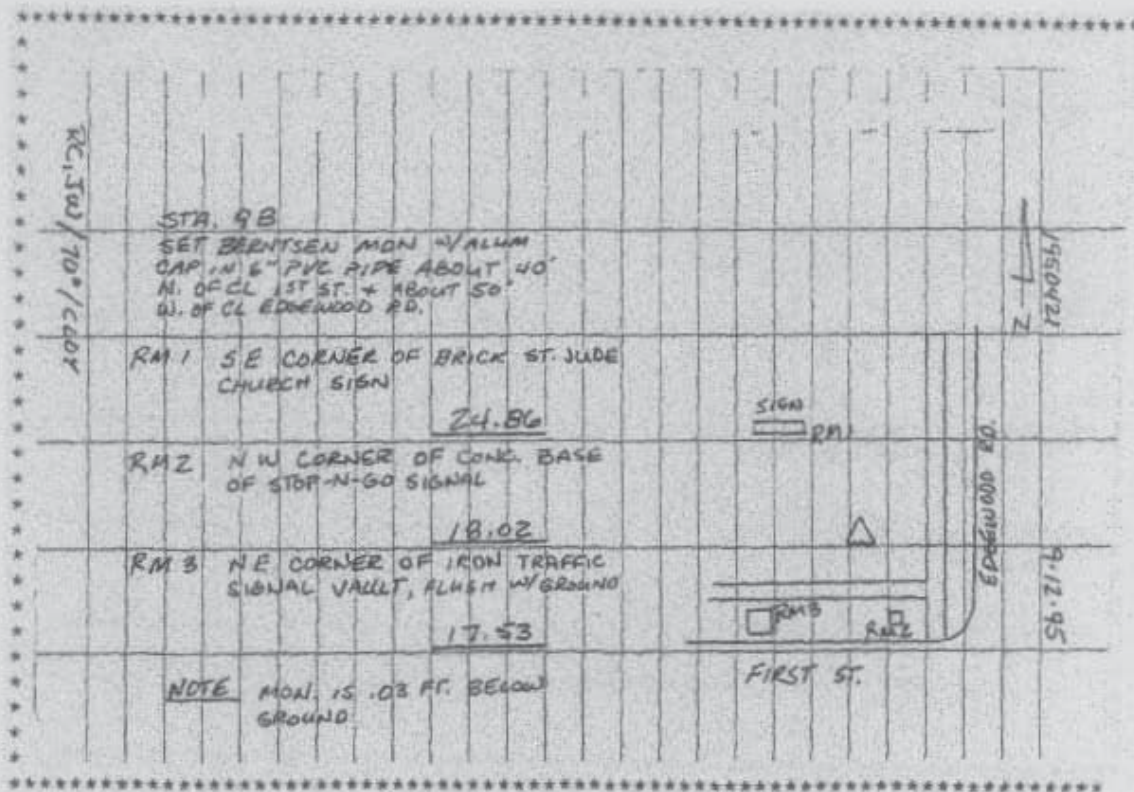

Prepared by DCI and GBC for Linn Co. and the City of Cedar Rapids, Iowa (Revised 08-05-05).