

Linn County and the City of Cedar Rapids, Iowa
 Iowa North Zone (1401)
 Horiz. Datum: NAD83(1996)
 Vert. Datum: NAVD 1988
 US Survey Feet
2005

Point Name: **Linn 25**

Designation: LINN COUNTY GPS CONTROL PT. 2005-025, set by DCI for Linn Co. in 2005

Northing: **3528548.23**sft Easting: **5388872.91**sft

Orthometric Height: **858.11**sft Ellipsoid Height: **755.03**sft **Geoid03**

Latitude: **42°09'59.95402"N** Longitude: **91°46'30.00162"W**

Mapping Angle: **1°10'09"** Combination Scale Factor: **0.99994733**

Monument Type: Berntsen Top Security Rod Monument with a 2-1/2" dia. domed survey cap and permanent magnet encased in a 5"dia. PVC pipe with a NGS style aluminum access cover.

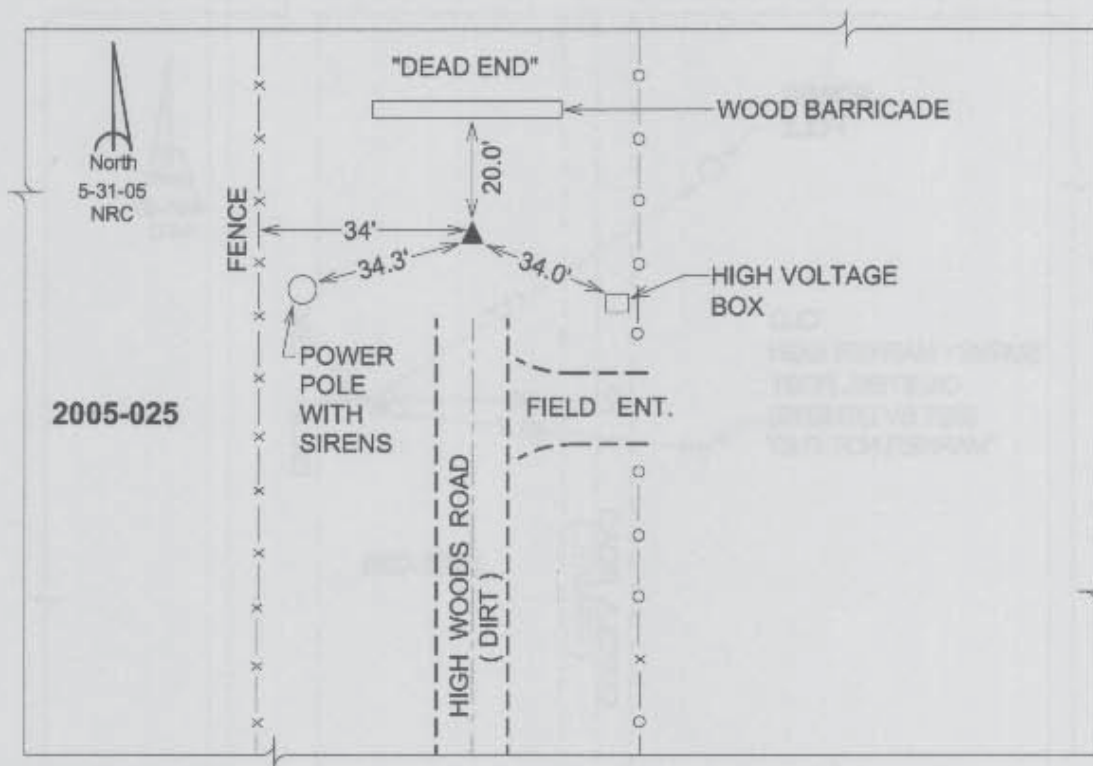

Prepared by DCI and GBC for Linn Co. and the City of Cedar Rapids, Iowa (Revised 08-05-05).