

Linn County and the City of Cedar Rapids, Iowa
Iowa North Zone (1401)
Horiz. Datum: NAD83(1996)
Vert. Datum: NAVD 1988
US Survey Feet
2005

Point Name: **Linn 32**

Designation: LINN COUNTY GPS CONTROL PT. 2005-032, set by DCI for Linn Co. in 2005

Northing: **3519101.25sft** Easting: **5398889.03sft**

Orthometric Height: **818.46sft** Ellipsoid Height: **714.83sft** **Geoid03**

Latitude: **42°08'24.60924"N** Longitude: **91°44'19.63960"W**

Mapping Angle: **1°11'37"** Combination Scale Factor: **0.99995336**

Monument Type: Berntsen Top Security Rod Monument with a 2-1/2" dia. domed survey cap and permanent magnet encased in a 5"dia. PVC pipe with a NGS style aluminum access cover.

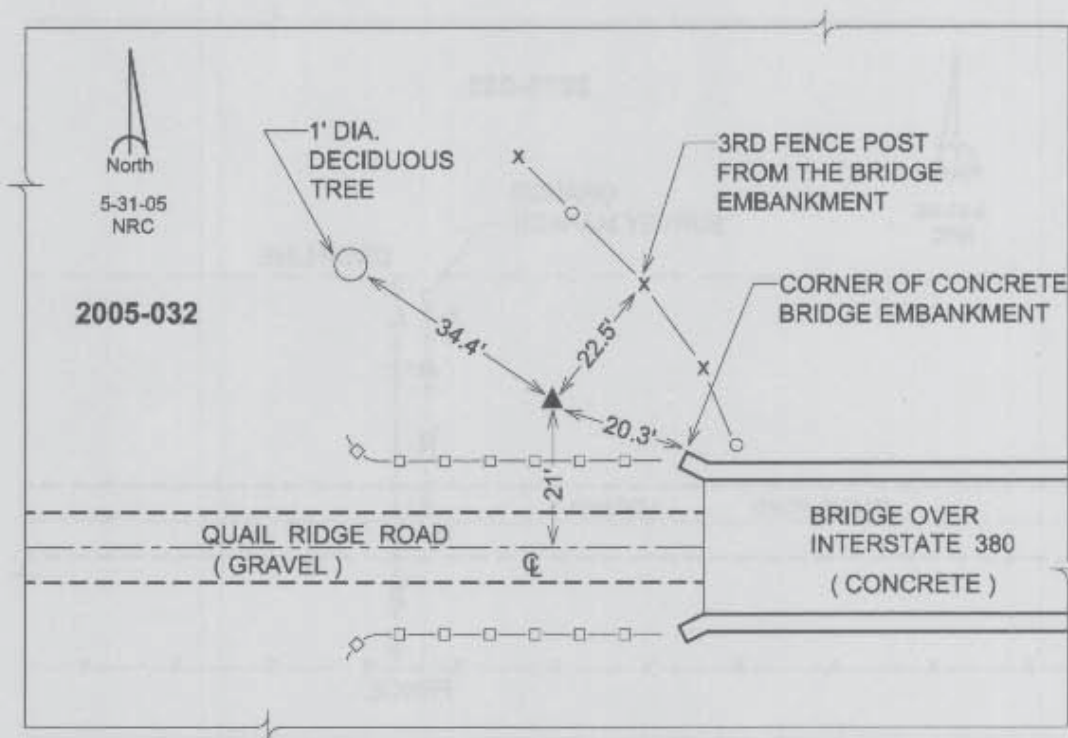

Linn County and the City of Cedar Rapids, Iowa

Prepared by DCI and GBC for Linn Co. and the City of Cedar Rapids, Iowa (Revised 08-05-05).