

Linn County and the City of Cedar Rapids, Iowa
 Iowa North Zone (1401)
 Horiz. Datum: NAD83(1996)
 Vert. Datum: NAVD 1988
 US Survey Feet
2005

Point Name: **Linn 5A**

Designation: Station 5A, Set by the Surdex Corp. for Linn County in 2000

Northing: **3555750.77sft** Easting: **5483058.20sft**

Orthometric Height: **965.54sft** Ellipsoid Height: **861.15sft** **Geoid03**

Latitude: **42°14'07.70595"N** Longitude: **91°25'30.82330"W**

Mapping Angle: **1°24'22"** Combination Scale Factor: **0.99993256**

Monument Type: Aluminum Cap on 6-foot Rebar set in a 6" dia. PVC pipe with an aluminum access cover.

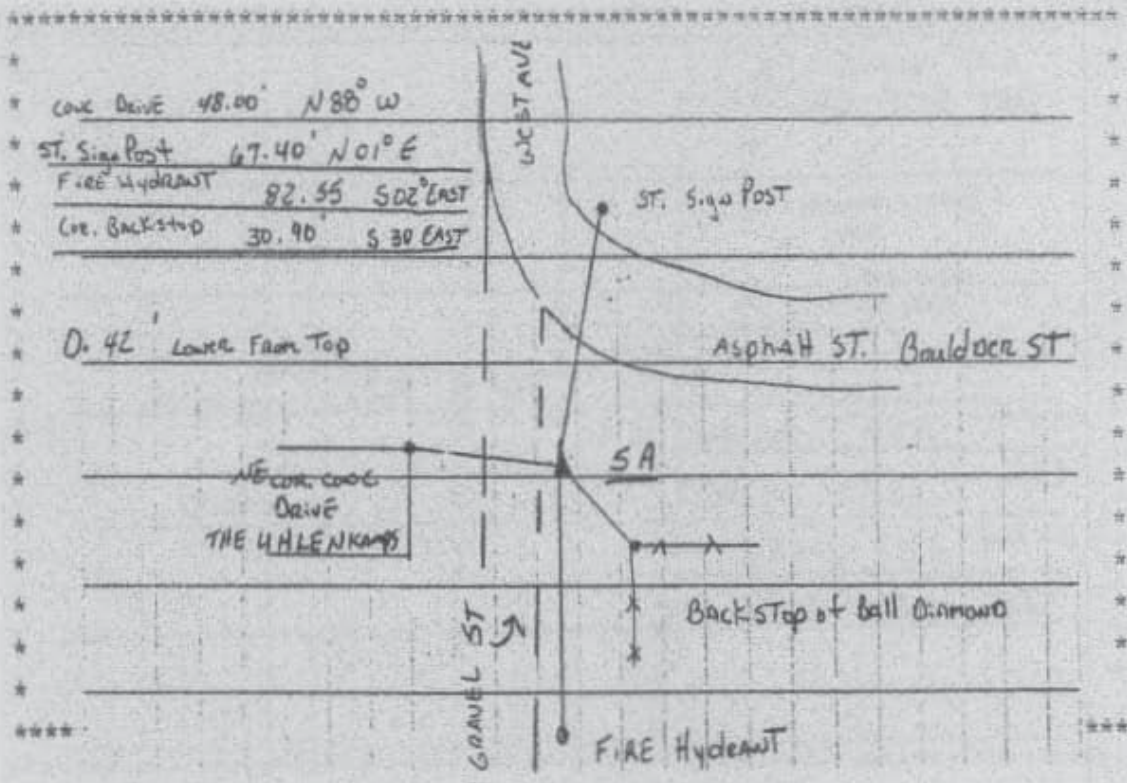

Prepared by DCI and GBC for Linn Co. and the City of Cedar Rapids, Iowa (Revised 08-05-05).