

Linn County and the City of Cedar Rapids, Iowa  
Iowa North Zone (1401)  
Horiz. Datum: NAD83(1996)  
Vert. Datum: NAVD 1988  
US Survey Feet  
2005

Point Name: Linn 6

**Designation:** Station 6, Set by the Surdex Corp. for Linn County in 2000

Northing: 3578308.49sft Easting: 5499240.43sft

Orthometric Height: 1038.53sft Ellipsoid Height: 934.62sft **Geoid03**

Latitude: 42°17'46.49738"N Longitude: 91°21'48.19451"W

Mapping Angle: 1°26'53" Combination Scale Factor: 0.99992167

**Monument Type:** Aluminum Cap on 6-foot Rebar set in a 6" dia. PVC pipe with an aluminum access cover.

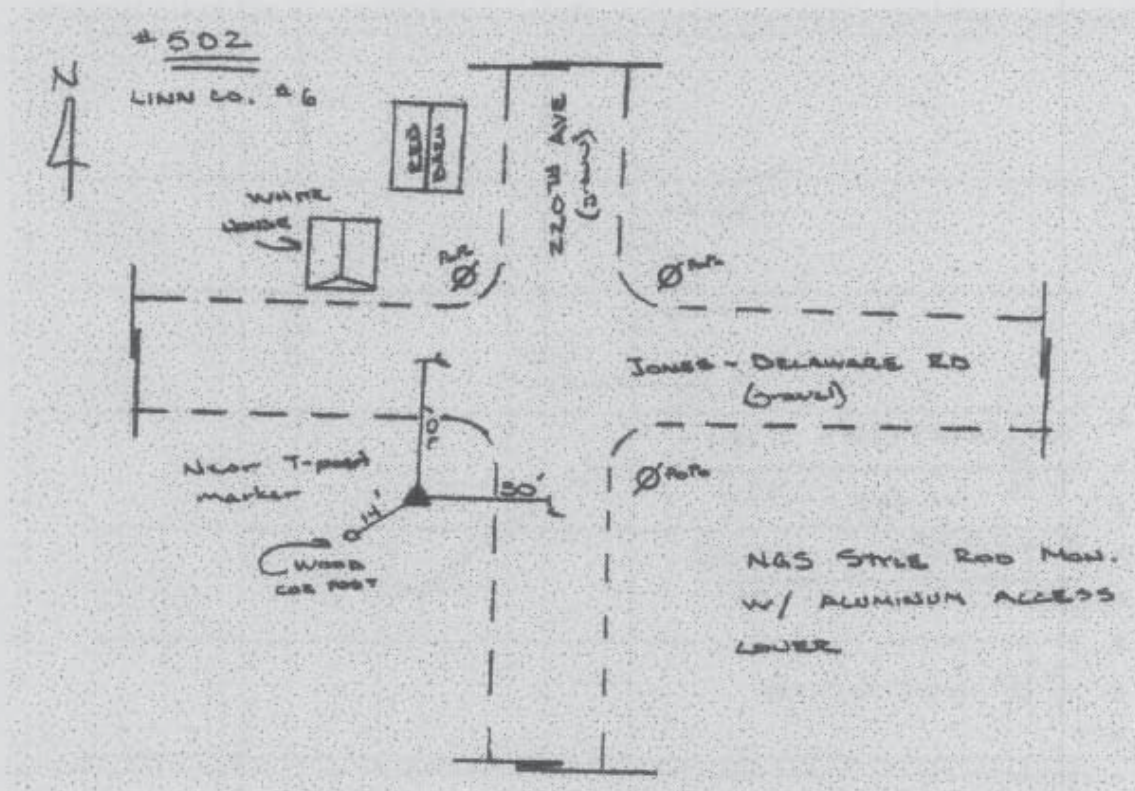

Prepared by DCI and GBC for Linn Co. and the City of Cedar Rapids, Iowa (Revised 08-05-05).