

Linn County and the City of Cedar Rapids, Iowa
 Iowa North Zone (1401)
 Horiz. Datum: NAD83(1996)
 Vert. Datum: NAVD 1988
 US Survey Feet
2005

Point Name: **Linn 8**

Designation: Station 8, Set by the Surdex Corp. for Linn County in 2000

Northing: **3545508.42sft** Easting: **5456511.12sft**

Orthometric Height: **844.28sft** Ellipsoid Height: **740.02sft** **Geoid03**

Latitude: **42°12'32.83557"N** Longitude: **91°31'26.81405"W**

Mapping Angle: **1°20'21"** Combination Scale Factor: **0.99994188**

Monument Type: Aluminum Cap on 6-foot Rebar set in a 6" dia. PVC pipe with an aluminum access cover.

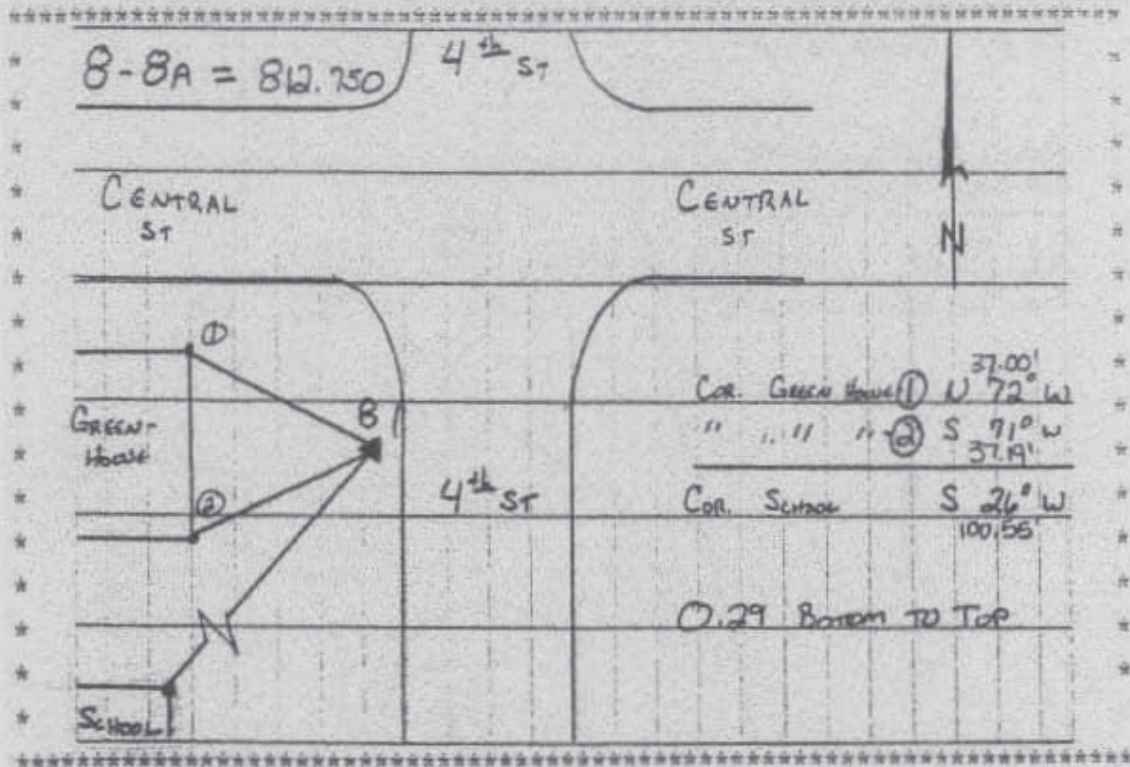

Prepared by DCI and GBC for Linn Co. and the City of Cedar Rapids, Iowa (Revised 08-05-05).