

Louisa County, Iowa
 Iowa South Zone (1402)
 Horiz. Datum: NAD83(NSRS2007)
 Vert. Datum: NAVD 1988
 US Survey Feet
2007

Point Name: **209**

Designation: 99-209 Des Moines Co GPS Control Pt. (set by ASI in 1999)

Northing: **398478.98sft** Easting: **2227455.84sft**

Orthometric Height: **724.80sft** Ellipsoid Height: **616.54sft** **Geoid03**

Latitude: **41°04'26.41798"N** Longitude: **91°22'14.17500"W**

Mapping Angle: **1°24'09"** Combination Scale Factor: **0.99992139**

Monument Type: Berntsen Top Security Rod Monument with a 2-1/2" dia. domed survey cap and permanent magnet encased in a 5" dia. PVC pipe with a NGS style aluminum access cover.

To Reach: 40ft S of 270th St, 28ft E of Des Moines-Henry Av. Near the NW cor of Sec 6 T72N R4W.

Date Printed July 30, 1999

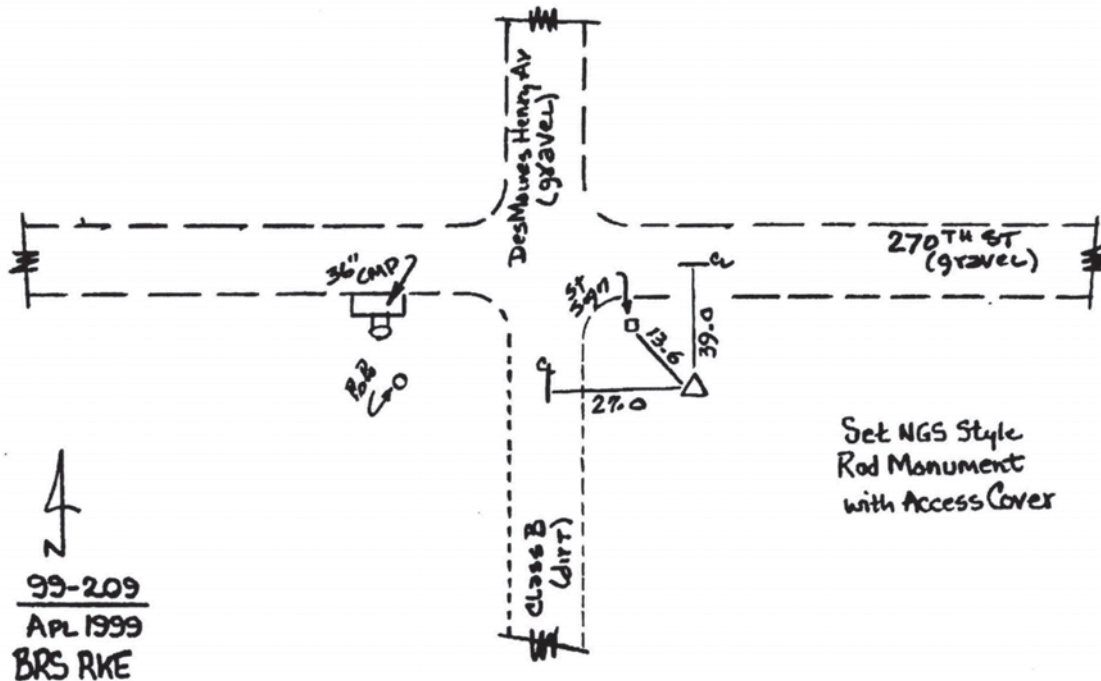

This document was prepared by DCI and GBC for use by Louisa County, Iowa.